

FUJILOK BOLT N A Type · B Type Dimension Table

A Type

Hexagon Headed Bolt
Thread accuracy ISO6g (JIS 6g)

Bolt	SS400
Lock Ring	Polyamide Resin Type 66

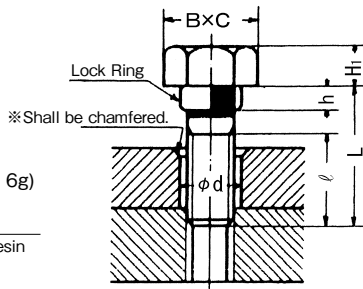

B Type

Hexagon Socket Head Cap Bolt
Thread accuracy ISO6g (JIS 6g)

Bolt	SCM435H
Lock Ring	Polyamide Resin Type 66

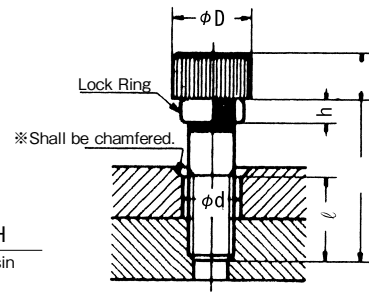

※Refer to JIS B1001 for chamfer dimension

S	Size	5	6	8	10	12	14	16	18	20	22	24	27	30							
	P	Pitch	0.8	1	1.25	1.5	1.75	2	2	2.5	2.5	2.5	3	3	3.5						
A T Y P E	B	Base	8	10	13	17	19	22	24	27	30	32	36	41	46						
		Tolerance	-0.5 ⁰	-0.6 ⁰	-0.7 ⁰	-0.8 ⁰				-1 ⁰											
C	Base	9.2	11.5	15	19.6	21.9	25.4	27.7	31.2	34.6	37	41.6	47.3	53.1							
	H ₁	Base	3.5	4	5.5	7	8	9	10	12	13	14	15	17	19						
B T Y P E	phi D	Base	8.5	10	13	16	18	21	24	27	30	33	36	40	45						
		Tolerance	-0.36 ⁰	-0.43 ⁰	-0.52 ⁰				-0.62 ⁰												
H ₂	Base	5	6	8	10	12	14	16	18	20	22	24	27	30							
	Tolerance	-0.3 ⁰	-0.36 ⁰	-0.43 ⁰				-0.62 ⁰													
C o m m o n	h	Base	3.5	3.5	4.5	5	6	6	6	8	8	10	10	12	12						
		Tolerance	± 0.15	± 0.2				± 0.3													
phi d	Base	6.0	7.2	9.5	12	14	16	19	21	23	25	27	31	35							
	Tolerance	$+0.3$ ⁰						$+0.4$ ⁰													
Neck Bottom Dimension L	30	30	35	40	45	50	60	70	80	90	100	110	120	130	140	150	160	170	180	190	200
	35	35																			

■All FUJILOK BOLT N are made to order. Need separate consultant for special sizes.