

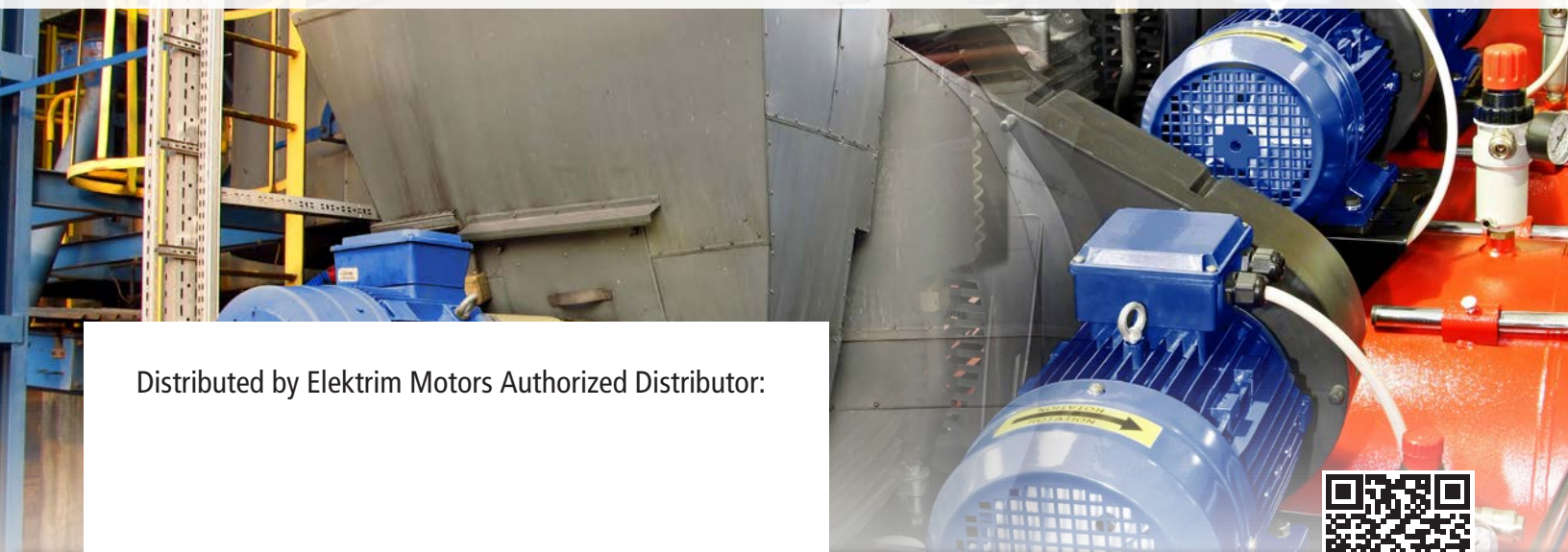

BUILT TO PERFORM WHERE OTHERS FAIL

A Full Line of Low Voltage IEC Motors In-Stock

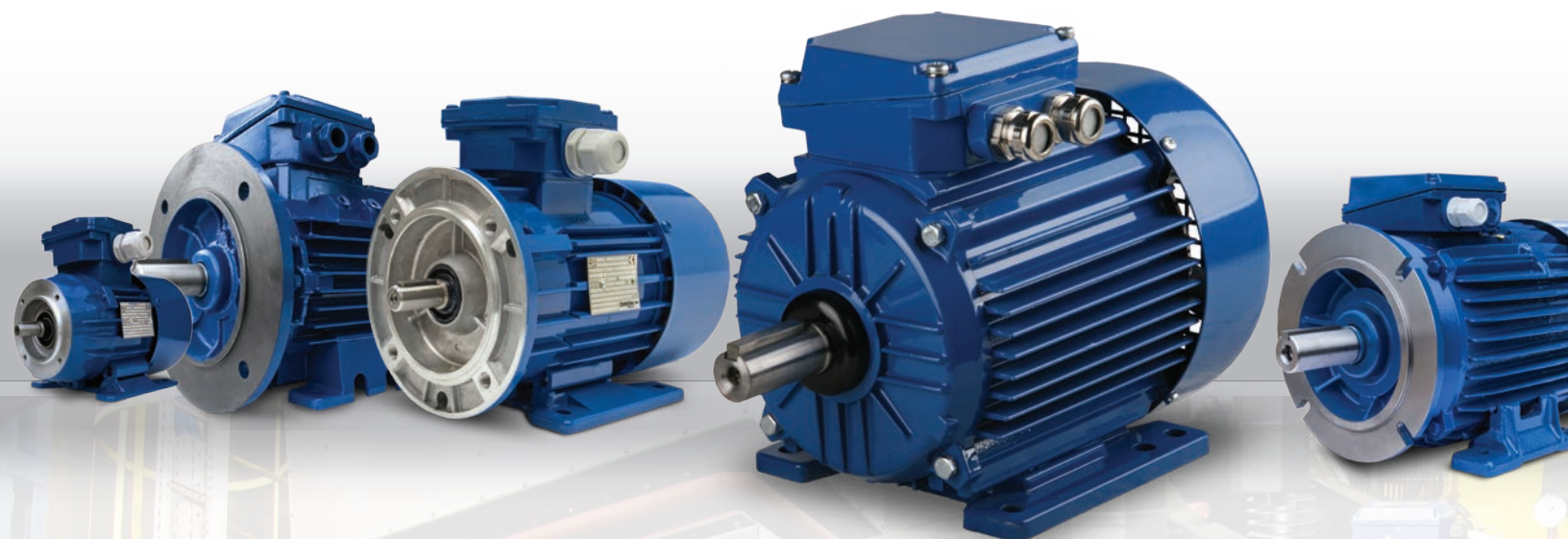

Distributed by Elektrim Motors Authorized Distributor:

www.elektrimmotors.com or call 855-Go-Elektrim





0.08-220HP Low Voltage IEC Motors

Solid Severe Duty Motors for Export and Replacement of Overseas Applications

3PH TEFC 60/50 Hz NEMA AC Foot Mounted, D-Flange and C-Face Motors

Features

- Comply with EISA 2007
- High locked rotor torque
- Inverter Duty Rated: 5:1CT & 10:1VT (at 460V 60Hz)
- Protection Degree: IP55
- Enclosure: TEFC F3 Rigid Cast Iron Frame
- Warranty: 3-Years
- Electromagnetic compatibility standards: EN 50081-1(2) and EN 50082-1(2)
- 56-132 frame have removable feet
- 90-112 frame motors have rotatable feet
- Terminal board standard up to and including IEC112
- VPI process applied for best electrical performance
- Oversized ball bearings on both ends: Double shielded up to IEC180, regreasable IEC200 and up
- Aluminum motor housing up to IEC112, cast iron above
- Nameplate rated 230/460V 60 Hz and 380/400V 50 Hz
- 132 frame and up are 12 lead motors allowing for 60 Hz 208/230/460/575/796V and 50 Hz 190/220/380/400/415/690V
- Class "F" insulation
- Drilled and tapped end shaft
- All motors provided with CE mark

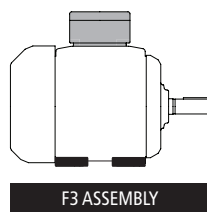

Getting the Right Flange for Your Motor Has Never Been Easier.

Order flanges pre-installed or buy separately.

Available D-Flanges



Standard B5 D-Flange



Reduction B5 D-Flange

Available C-Flanges



Standard B14 C-Flange



Increased B14 C-Flange

Std Bracket



Standard Bracket



B3 Foot Mounted IEC Frame Metric Motors – 0.08-220 HP

3PH TEFC Dual Rated 230/460V 60 Hz and 380/400V 60 Hz

Elektrim Motors with Foot Mounted Motors with Bracket are denoted by "MFM" in part number prefix, ex: 20MFM-3-3-18.

HP	kW	RPM	Frame	Footed B3 Part Number	List Price
0.08	0.06	1800	56	40MFM-3-.08-18	202.00
0.12	0.09	3600	56	40MFM-3-.12-36	208.00
		1800	56	40MFM-3-.12-18	208.00
0.17	0.12	3600	56	40MFM-3-.17-36	212.00
		1800	63	40MFM-3-.17-18	216.00
0.25	0.18	3600	63	40MFM-3-.25-36	217.00
		1800	63	40MFM-3-.25-18	223.00
		1200	71	40MFM-3-.25-12	252.00
0.33	0.25	3600	63	40MFM-3-.33-36	229.00
		1800	71	40MFM-3-.33-18	229.00
		1200	71	40MFM-3-.33-12	267.00
0.5	0.37	3600	71	40MFM-3-.50-36	245.00
		1800	71	40MFM-3-.50-18	245.00
		1200	80	40MFM-3-.50-12	323.00
0.75	0.55	3600	71	40MFM-3-.75-36	267.00
		1800	80	40MFM-3-.75-18	305.00
		1200	80	40MFM-3-.75-12	363.00
1	0.75	3600	80	40MFM-3-1-36	334.00
		1800	80	40MFM-3-1-18	311.00
		1200	90S	20MFM-3-1-12	657.00
1.5	1.1	3600	80	40MFM-3-1.5-36	362.00
		1800	90S	20MFM-3-1.5-18	633.00
2	1.5	3600	90S	20MFM-3-2-36	616.00
		1800	90L	20MFM-3-2-18	671.00
3	2.2	3600	90L	20MFM-3-3-36	763.00
		1800	100L	20MFM-3-3-18	755.00
		1200	112M	20MFM-3-3-12	1,135.00
4	3	3600	100L	20MFM-3-4-36	845.00
		1800	100L	20MFM-3-4-18	869.00
		1200	132S	20MFM-3-4-12	1,498.00
5.5	4	3600	112M	20MFM-3-5.5-36	928.00
		1800	112M	20MFM-3-5.5-18	927.00
		1200	132M	20MFM-3-5.5-12	1,507.00
7.5	5.5	3600	132S	20MFM-3-7.5-36	1,150.00
		1800	132S	20MFM-3-7.5-18	1,308.00
		1200	132M	20MFM-3-7.5-12	2,448.00

HP	kW	RPM	Frame	Footed B3 Part Number	List Price
10	7.5	3600	132S	20MFM-3-10-36	1,302.00
		1800	132M	20MFM-3-10-18	1,503.00
		1200	160M	20MFM-3-10-12	2,536.00
15	11	3600	160M	20MFM-3-15-36	1,815.00
		1800	160M	20MFM-3-15-18	1,862.00
		1200	160L	20MFM-3-15-12	3,010.00
20	15	3600	160M	20MFM-3-20-36	2,150.00
		1800	160L	20MFM-3-20-18	2,236.00
		1200	180L	20MFM-3-20-12	3,622.00
25	18.5	3600	160L	20MFM-3-25-36	2,594.00
		1800	180M	20MFM-3-25-18	2,726.00
		1200	200L	20MFM-3-25-12	5,845.00
30	22	3600	180M	20MFM-3-30-36	3,130.00
		1800	180L	20MFM-3-30-18	3,396.00
		1200	200L	20MFM-3-30-12	6,151.00
40	30	3600	200L	20MFM-3-40-36	7,275.00
		1800	200L	20MFM-3-40-18	5,982.00
		1200	225M	20MFM-3-40-12	7,952.00
50	37	3600	200L	20MFM-3-50-36	8,009.00
		1800	225S	20MFM-3-50-18	7,666.00
		1200	250M	20MFM-3-50-12	9,958.00
60	45	3600	225M	20MFM-3-60-36	8,833.00
		1800	225M	20MFM-3-60-18	8,696.00
		1200	280S	20MFM-3-60-12	13,495.00
75	55	3600	250M	20MFM-3-75-36	11,457.00
		1800	250M	20MFM-3-75-18	9,704.00
		1200	280M	20MFM-3-75-12	14,440.00
100	75	3600	280S	20MFM-3-100-36	12,803.00
		1800	280S	20MFM-3-100-18	12,761.00
		1200	315S	20MFM-3-100-12	19,873.00
125	90	3600	280M	20MFM-3-125-36	15,595.00
		1800	280M	20MFM-3-125-18	13,775.00
		1200	315M	20MFM-3-125-12	22,096.00
150	110	1800	315M	20MFM-3-150-18	19,583.00
220	160	1800	315M	20MFM-3-220-18	27,253.00

IE3 Premium Efficient Motors

Don't see your rating?

We have more available options than shown. Call Elektrim to learn more about our IEC custom motor solutions and quick modifications.

FLANGES - VOLTAGE RE-RATES - HP/KW UP/DE-RATING - SHAFT TURN DOWN - DRIP COVERS - AND MUCH MORE



STANDARD B35 Foot Mounted D-Flange IEC Frame Metric Motors – 0.08-220 HP 3PH TEFC Dual Rated 230/460V 60 Hz and 380/400V 60 Hz

Elektrim Motors with D-Flange pre-installed are denoted by "MDM" in part number prefix, ex: 20MDM-3-3-18.

HP	kW	RPM	Frame	D-Flange B35 Part Number	List Price
0.08	0.06	1800	56	40MDM-3-.08-18	220.00
0.12	0.09	3600	56	40MDM-3-.12-36	227.00
		1800	56	40MDM-3-.12-18	227.00
		3600	56	40MDM-3-.17-36	231.00
0.17	0.12	1800	63	40MDM-3-.17-18	235.00
		3600	63	40MDM-3-.25-36	237.00
0.25	0.18	1800	63	40MDM-3-.25-18	243.00
		1200	71	40MDM-3-.25-12	275.00
		3600	63	40MDM-3-.33-36	250.00
0.33	0.25	1800	71	40MDM-3-.33-18	250.00
		1200	71	40MDM-3-.33-12	291.00
		3600	71	40MDM-3-.50-36	267.00
0.5	0.37	1800	71	40MDM-3-.50-18	267.00
		1200	80	40MDM-3-.50-12	352.00
		3600	71	40MDM-3-.75-36	291.00
0.75	0.55	1800	80	40MDM-3-.75-18	332.00
		1200	80	40MDM-3-.75-12	396.00
		3600	80	40MDM-3-1-36	364.00
1	0.75	1800	80	40MDM-3-1-18	339.00
		1200	90S	20MDM-3-1-12	716.00
		3600	80	40MDM-3-1.5-36	395.00
1.5	1.1	1800	90S	20MDM-3-1.5-18	690.00
		3600	90S	20MDM-3-2-36	671.00
2	1.5	1800	90L	20MDM-3-2-18	731.00
		3600	90L	20MDM-3-3-36	832.00
3	2.2	1800	100L	20MDM-3-3-18	823.00
		1200	112M	20MDM-3-3-12	1,237.00
		3600	100L	20MDM-3-4-36	921.00
4	3	1800	100L	20MDM-3-4-18	947.00
		1200	132S	20MDM-3-4-12	1,633.00
		3600	112M	20MDM-3-5.5-36	1,012.00
5.5	4	1800	112M	20MDM-3-5.5-18	1,010.00
		1200	132M	20MDM-3-5.5-12	1,643.00
		3600	132S	20MDM-3-7.5-36	1,254.00
7.5	5.5	1800	132S	20MDM-3-7.5-18	1,426.00
		1200	132M	20MDM-3-7.5-12	2,668.00

HP	kW	RPM	Frame	D-Flange B35 Part Number	List Price
10	7.5	3600	132S	20MDM-3-10-36	1,419.00
		1800	132M	20MDM-3-10-18	1,638.00
		1200	160M	20MDM-3-10-12	2,764.00
15	11	3600	160M	20MDM-3-15-36	1,978.00
		1800	160M	20MDM-3-15-18	2,030.00
		1200	160L	20MDM-3-15-12	3,281.00
20	15	3600	160M	20MDM-3-20-36	2,344.00
		1800	160L	20MDM-3-20-18	2,437.00
		1200	180L	20MDM-3-20-12	3,948.00
25	18.5	3600	160L	20MDM-3-25-36	2,827.00
		1800	180M	20MDM-3-25-18	2,971.00
		1200	200L	20MDM-3-25-12	6,371.00
30	22	3600	180M	20MDM-3-30-36	3,412.00
		1800	180L	20MDM-3-30-18	3,702.00
		1200	200L	20MDM-3-30-12	6,705.00
40	30	3600	200L	20MDM-3-40-36	7,930.00
		1800	200L	20MDM-3-40-18	6,520.00
		1200	225M	20MDM-3-40-12	8,668.00
50	37	3600	200L	20MDM-3-50-36	8,730.00
		1800	225S	20MDM-3-50-18	8,356.00
		1200	250M	20MDM-3-50-12	10,854.00
60	45	3600	225M	20MDM-3-60-36	9,628.00
		1800	225M	20MDM-3-60-18	9,479.00
		1200	280S	20MDM-3-60-12	14,710.00
75	55	3600	250M	20MDM-3-75-36	12,488.00
		1800	250M	20MDM-3-75-18	10,577.00
		1200	280M	20MDM-3-75-12	15,740.00
100	75	3600	280S	20MDM-3-100-36	13,955.00
		1800	280S	20MDM-3-100-18	13,909.00
		1200	315S	20MDM-3-100-12	21,662.00
125	90	3600	280M	20MDM-3-125-36	16,999.00
		1800	280M	20MDM-3-125-18	15,015.00
		1200	315M	20MDM-3-125-12	24,085.00
150	110	1800	315M	20MDM-3-150-18	21,345.00
220	160	1800	315M	20MDM-3-220-18	29,706.00

IE3 Premium Efficient Motors

Stand-Alone B5 Standard D-Flanges

To make a B35 standard B5 (D-Flange) flange motor with feet.

FRAME	Flange Mount M/N/P	20M & 40M Series	
		Flange Part #	List Price
56	100/80/120	41DM-FLA-56	92.00
63	115/95/140	41DM-FLA-63	104.00
71	130/110/160	41DM-FLA-71	161.00
80	165/130/200	41DM-FLA-80	190.00
90	165/130/200	41DM-FLA-90	228.00
100	215/180/250	41DM-FLA-100	335.00
112	215/180/250	41DM-FLA-112	419.00
132	265/230/300	41DM-FLA-132	491.00

FRAME	Flange Mount M/N/P	20M & 40M Series	
		Flange Part #	List Price
160	300/250/350	41DM-FLA-160	958.00
180	300/250/350	41DM-FLA-180	1,046.00
200-2,4,6P	400/350/300	22DM-FLA-200	1,206.00
225-2,4,6P	450/400/350	22DM-FLA-225	1,354.00
250-2,4,6P	550/500/450	22DM-FLA-250	1,947.00
280-4,6P	550/500/450	22DM-FLA-280	2,102.00
280-2P	550/500/450	22DM-FLA-280-2P	2,102.00
315-4,6P	660/600/550	22DM-FLA-315	2,916.00

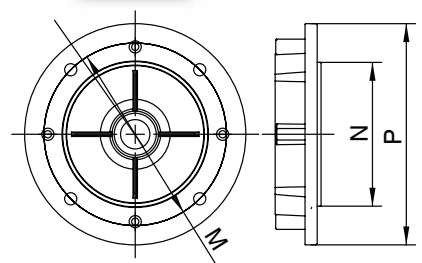



REDUCTION B35 Foot Mounted D-Flange IEC Frame Metric Motors – 1-25 HP

3PH TEFC Dual Rated 230/460V 60 Hz and 380/400V 60 Hz

Elektrim Motors with Reduction D-Flange pre-installed are denoted by "MDM" in part number prefix with a "/R" suffix, ex: 20MDM-3-3-18/R.

HP	kW	RPM	Frame	D-Flange B35 Reduction Part #	List Price
1	0.75	1200	90S	20MDM-3-1-12/R	716.00
1.5	1.1	1800	90S	20MDM-3-1.5-18/R	690.00
2	1.5	3600	90S	20MDM-3-2-36/R	671.00
		1800	90L	20MDM-3-2-18/R	731.00
3	2.2	3600	90L	20MDM-3-3-36/R	832.00
		1800	100L	20MDM-3-3-18/R	823.00
		1200	112M	20MDM-3-3-12/R	1,237.00
4	3	3600	100L	20MDM-3-4-36/R	921.00
		1800	100L	20MDM-3-4-18/R	947.00
		1200	132S	20MDM-3-4-12/R	1,633.00
5.5	4	3600	112M	20MDM-3-5.5-36/R	1,012.00
		1800	112M	20MDM-3-5.5-18/R	1,010.00
		1200	132M	20MDM-3-5.5-12/R	1,643.00
7.5	5.5	3600	132S	20MDM-3-7.5-36/R	1,254.00
		1800	132S	20MDM-3-7.5-18/R	1,426.00
		1200	132M	20MDM-3-7.5-12/R	2,668.00

HP	kW	RPM	Frame	D-Flange B35 Reduction Part #	List Price
10	7.5	3600	132S	20MDM-3-10-36/R	1,419.00
		1800	132M	20MDM-3-10-18/R	1,638.00
		1200	160M	20MDM-3-10-12/R	2,764.00
15	11	3600	160M	20MDM-3-15-36/R	1,978.00
		1800	160M	20MDM-3-15-18/R	2,030.00
		1200	160L	20MDM-3-15-12/R	3,281.00
20	15	3600	160M	20MDM-3-20-36/R	2,344.00
		1800	160L	20MDM-3-20-18/R	2,437.00
25	18.5	3600	160L	20MDM-3-25-36/R	2,827.00

IE3 Premium Efficient Motors

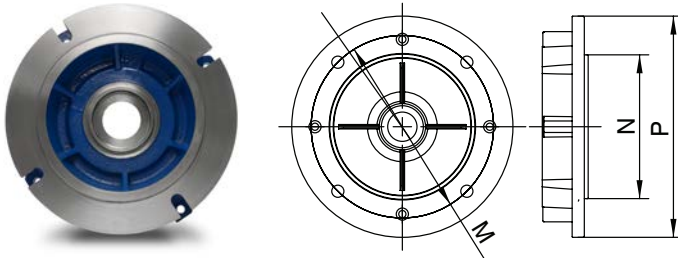

Stand-Alone B5 Reduced D-Flanges

To make a B35 non-standard reduction B5 (D-Flange) flange motor with feet.

FRAME	Description	Flange Mount M/N/P	20M Series	
			Flange Part Number	List Price
90	Reduced IEC71 B5	130/110/160	41DM-FLA-90/R	228.00
100	Reduced IEC80/90 B5	165/130/200	41DM-FLA-100/R	335.00
112	Reduced IEC80/90 B5	165/130/200	41DM-FLA-112/R	419.00
132	Reduced IEC100/112 B5	215/180/250	41DM-FLA-132/R	491.00
160	Reduced IEC132 B5	265/230/300	41DM-FLA-160/R	958.00

BUILT TO PERFORM WHERE OTHERS FAIL



STANDARD B34 Foot Mounted C-Flange IEC Frame Metric Motors – 0.08-20 HP

3PH TEFC Dual Rated 230/460V 60 Hz and 380/400V 60 Hz

Elektrim Motors with Increased C-Flange pre-installed are denoted by "MCM" in part number prefix, ex: 20MCM-3-3-18.

HP	kW	RPM	Frame	C-Face B34 Increased Part #	List Price
0.08	0.06	1800	56	40MCM-3-.08-18	220.00
0.12	0.09	3600	56	40MCM-3-.12-36	227.00
		1800	56	40MCM-3-.12-18	227.00
0.17	0.12	3600	56	40MCM-3-.17-36	231.00
		1800	63	40MCM-3-.17-18	235.00
0.25	0.18	3600	63	40MCM-3-.25-36	237.00
		1800	63	40MCM-3-.25-18	243.00
		1200	71	40MCM-3-.25-12	275.00
0.33	0.25	3600	63	40MCM-3-.33-36	250.00
		1800	71	40MCM-3-.33-18	250.00
		1200	71	40MCM-3-.33-12	291.00
0.5	0.37	3600	71	40MCM-3-.50-36	267.00
		1800	71	40MCM-3-.50-18	267.00
		1200	80	40MCM-3-.50-12	352.00
0.75	0.55	3600	71	40MCM-3-.75-36	291.00
		1800	80	40MCM-3-.75-18	332.00
		1200	80	40MCM-3-.75-12	396.00
1	0.75	3600	80	40MCM-3-1-36	364.00
		1800	80	40MCM-3-1-18	339.00
		1200	90S	20MCM-3-1-12	716.00
1.5	1.1	3600	80	40MCM-3-1.5-36	395.00
		1800	90S	20MCM-3-1.5-18	690.00
2	1.5	3600	90S	20MCM-3-2-36	671.00
		1800	90L	20MCM-3-2-18	731.00

HP	kW	RPM	Frame	C-Face B34 Increased Part #	List Price
3	2.2	3600	90L	20MCM-3-3-36	832.00
		1800	100L	20MCM-3-3-18	823.00
		1200	112M	20MCM-3-3-12	1,237.00
4	3	3600	100L	20MCM-3-4-36	921.00
		1800	100L	20MCM-3-4-18	947.00
		1200	132S	20MCM-3-4-12	1,633.00
5.5	4	3600	112M	20MCM-3-5.5-36	1,012.00
		1800	112M	20MCM-3-5.5-18	1,010.00
		1200	132M	20MCM-3-5.5-12	1,643.00
7.5	5.5	3600	132S	20MCM-3-7.5-36	1,254.00
		1800	132S	20MCM-3-7.5-18	1,426.00
		1200	132M	20MCM-3-7.5-12	2,668.00
10	7.5	3600	132S	20MCM-3-10-36	1,419.00
		1800	132M	20MCM-3-10-18	1,638.00
		1200	160M	20MCM-3-10-12	2,764.00
15	11	3600	160M	20MCM-3-15-36	1,978.00
		1800	160M	20MCM-3-15-18	2,030.00
		1200	160L	20MCM-3-15-12	3,281.00
20	15	3600	160M	20MCM-3-20-36	2,344.00
		1800	160L	20MCM-3-20-18	2,437.00

IE3 Premium Efficient Motors

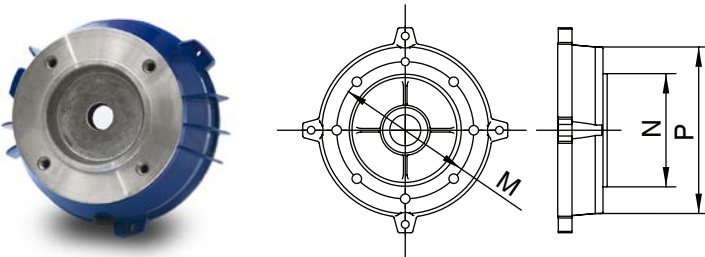

Stand-Alone B14 Standard C-Flanges

To make a B34 standard B14 (C-Face) flange motor with feet.

FRAME	Flange Mount	20M & 40M Series	
	M/N/P	Flange Part Number	List Price
56	65/50/80	41CM-FLA-56/2	79.00
63	75/60/90	41CM-FLA-63/2	84.00
71	85/70/105	41CM-FLA-71/2	133.00
80	100/80/120	41CM-FLA-80/2	200.00
90	115/95/140	41CM-FLA-90/2	274.00
100	130/110/160	41CM-FLA-100/2	409.00
112	130/110/160	41CM-FLA-112/2	501.00
132	165/130/200	41CM-FLA-132/2	544.00
160	215/180/250	41CM-FLA-160/2	919.00



INCREASED B34/1 Foot Mounted C-Flange IEC Frame Metric Motors – 0.08-20 HP

3PH TEFC Dual Rated 230/460V 60 Hz and 380/400V 60 Hz

Elektrim Motors with Increased C-Flange pre-installed are denoted by "MCM" in part number prefix with a "1" suffix, ex: 20MCM-3-3-18/1.

HP	kW	RPM	Frame	C-Face B34/1 Increased Part #	List Price
0.08	0.06	1800	56	40MCM-3-.08-18/1	220.00
0.12	0.09	3600	56	40MCM-3-.12-36/1	227.00
		1800	56	40MCM-3-.12-18/1	227.00
0.17	0.12	3600	56	40MCM-3-.17-36/1	231.00
		1800	63	40MCM-3-.17-18/1	235.00
0.25	0.18	3600	63	40MCM-3-.25-36/1	237.00
		1800	63	40MCM-3-.25-18/1	243.00
		1200	71	40MCM-3-.25-12/1	275.00
0.33	0.25	3600	63	40MCM-3-.33-36/1	250.00
		1800	71	40MCM-3-.33-18/1	250.00
		1200	71	40MCM-3-.33-12/1	291.00
0.5	0.37	3600	71	40MCM-3-.50-36/1	267.00
		1800	71	40MCM-3-.50-18/1	267.00
		1200	80	40MCM-3-.50-12/1	352.00
0.75	0.55	3600	71	40MCM-3-.75-36/1	291.00
		1800	80	40MCM-3-.75-18/1	332.00
		1200	80	40MCM-3-.75-12/1	396.00
1	0.75	3600	80	40MCM-3-1-36/1	364.00
		1800	80	40MCM-3-1-18/1	339.00
		1200	90S	20MCM-3-1-12/1	716.00
1.5	1.1	3600	80	40MCM-3-1.5-36/1	395.00
		1800	90S	20MCM-3-1.5-18/1	690.00
2	1.5	3600	90S	20MCM-3-2-36/1	671.00
		1800	90L	20MCM-3-2-18/1	731.00

HP	kW	RPM	Frame	C-Face B34/1 Increased Part #	List Price
3	2.2	3600	90L	20MCM-3-3-36/1	832.00
		1800	100L	20MCM-3-3-18/1	823.00
		1200	112M	20MCM-3-3-12/1	1,237.00
4	3	3600	100L	20MCM-3-4-36/1	921.00
		1800	100L	20MCM-3-4-18/1	947.00
		1200	132S	20MCM-3-4-12/1	1,633.00
5.5	4	3600	112M	20MCM-3-5.5-36/1	1,012.00
		1800	112M	20MCM-3-5.5-18/1	1,010.00
		1200	132M	20MCM-3-5.5-12/1	1,643.00
7.5	5.5	3600	132S	20MCM-3-7.5-36/1	1,254.00
		1800	132S	20MCM-3-7.5-18/1	1,426.00
		1200	132M	20MCM-3-7.5-12/1	2,668.00
10	7.5	3600	132S	20MCM-3-10-36/1	1,419.00
		1800	132M	20MCM-3-10-18/1	1,638.00
		1200	160M	20MCM-3-10-12/1	2,764.00
15	11	3600	160M	20MCM-3-15-36/1	1,978.00
		1800	160M	20MCM-3-15-18/1	2,030.00
		1200	160L	20MCM-3-15-12/1	3,281.00
20	15	3600	160M	20MCM-3-20-36/1	2,344.00
		1800	160L	20MCM-3-20-18/1	2,437.00

IE3 Premium Efficient Motors

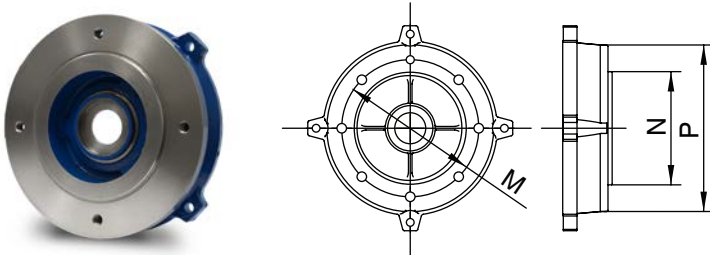

Stand-Alone B14 Increased C-Flanges

To make a B34/1 non-standard increased B14 (C-Face) flange motor with feet.

FRAME	Description	Flange Mount	20M & 40M Series		
			M/N/P	Flange Part Number	List Price
56	Increased IEC71 B14	85/70/105		41CM-FLA-56/1	79.00
63	Increased IEC80 B14	100/80/120		41CM-FLA-63/1	84.00
71	Increased IEC90 B14	115/95/140		41CM-FLA-71/1	133.00
80	Increased IEC100 B14	130/110/160		41CM-FLA-80/1	200.00
90	Increased IEC100 B14	130/110/160		41CM-FLA-90/1	274.00
100	Increased IEC132 B14	165/130/200		41CM-FLA-100/1	409.00
112	Increased IEC132 B14	165/130/200		41CM-FLA-112/1	501.00
132	Increased IEC160 B14	215/180/250		41CM-FLA-132/1	544.00
160	Reduced IEC132 B5	265/230/300		41CM-FLA-160/1	919.00

BUILT TO PERFORM WHERE OTHERS FAIL



ADVANCED CAPABILITIES

Low Voltage Metric IEC

Special Order Metric IEC Motors

IEC Frame Metric ATEX Certified Explosion Proof – 1-220 HP

3PH TEFC 50/60 Hz IEC AC Foot Mounted and D-Flange Motors

Applications: Designed for the hazardous applications found in the petroleum, natural gas, chemical and industrial paint industries where explosive mixtures of combustible gas, vapor or dust, classified as Group II, Temperature Class T5 or lower, may exist. Motors can be operated in Zone 1 & 2.



Features

- ATEX Certified
- Inverter Duty Rated
- Vacuum pressure impregnation (VPI) for the most dependable failsafe electrical performance
- Protection Degree: IP55
- Enclosure: TEFC F3 rigid cast iron frame
- Duty S1
- Voltage 400V and more available
- Class "F" insulation
- Ambient temperature from 20°C to +40°C (Class T5)
- Increased safety of terminal box
- Terminal box with 1 cable inlet
- Cable inlet Ant. terminals adapted for cable with copper wires
- 3 terminals for direct on-line starting
- According to standards: PN-EN 60034-1, PN-EN 60079-0, PN-EN 60079-1, PN-EN 60079-7
- Classified to Category 2G according to Directive 94/9/WE (ATEX)
- Warranty: 3-Years

Non-stock item available by special order.
**** For Export Market ****

IEC Large Frame Low Voltage Metric Motors – 220-1500 HP

3PH TEFC 50/60 Hz AC B3 Foot Mounted Motors

Applications: Designed to meet international standards as replacement motors for overseas applications and machinery such as pumps, conveyors, fans and more.



Features

- Inverter Duty Rated
- Design: "N" or "H"
- Protection Degree: IP55 or better
- Enclosure: TEFC
- High efficiency motors
- Vacuum pressure impregnation (VPI) for the most dependable failsafe electrical performance
- Electromagnetic compatibility standards: EN 50081-1(2) and EN 50082-1(2)
- Nameplate rated 380/400V 50 Hz or 460V 60 Hz
- Reduced vibration and noise level
- Class "F" insulation
- Oversized ball bearings on both ends for direct coupling
- Junction box equipped with glands
- F3 mounting position
- Drilled and tapped end shaft
- Drain plugs
- Bidirectional fan
- D-Flange available for most sizes
- All motors provided with CE mark
- Warranty: 12-Months from Installation, 18-Months from Purchase Date

Non-stock item available by special order.

Additional Special Order Metric Lines



- IEC Frame Medium Voltage Motors, 220-6300 HP
- IEC Frame Metric Brake Motors, 1-220 HP
- IEC Frame Metric 1-Phase Phase Motors, 0.50-3 HP, **For Export Market**
- IEC Frame Metric 3-Phase Motors with Foreign Cooling, 0.75-25 HP, **For Export Market**
- IEC Frame Metric Increased Safety Explosion Proof Motors, 1-30 HP, **For Export Market**
- IEC Frame Metric Marine Duty Motors, 0.25-30 HP, **For Ships and Export Market**

Some inventory available from stock. Please call 855-463-5358 for price, availability and/or special order.

You Might Also Be Interested In these Elektrim Lines:

Premium Efficient Motors



Premium Efficient Performance 20N Series

- 1-250 HP
- 3600-1800-1200 RPM
- NEMA Premium® TEFC IP55
- Dual Rated 60/50 Hz
- Inverter Rated 10:1CT 20:1VT
- Service Factor up to 1.4
- Vacuum Pressure Impregnation
- Oversized Bearings on both ends
- V-Ring or Labyrinth Seal
- Moisture Resistant Tropicalization

Applications

- Mills and Quarries
- Pumps and Conveyors
- Foundries and Chemical Plants



Premium Efficient Severe Duty 60N Series

- 1-250 HP
- 3600-1800-1200 RPM
- NEMA Premium® TEFC IP55
- Dual Rated 60/50 Hz
- Inverter Rated 10:1CT 20:1VT
- Service Factor up to 1.4
- Vacuum Pressure Impregnation
- Oversized Bearings on both ends
- V-Ring or Labyrinth Seal
- Moisture Resistant Tropicalization
- Low Vibration Level <0.08 in/sec

Applications

- Mills, Quarries and Crushers
- Foundries and Chemical Plants

Other Metric Motor Options



Larger Metric Low Voltage

- 220-1500 HP
- 3600-1800-1200 RPM
- TEFC IP55 or Better
- Dual Rated 60/50 Hz
- Inverter Duty Rated
- Vacuum Pressure Impregnation
- Oversized Bearings on both ends

Applications

- Pumps
- Conveyors
- Fans and Blowers
- Mills
- Mineral Processing
- Waste Management Facilities



Metric Medium Voltage

- 220-6300 HP
- 2, 4, 6, 8, and 10 Pole
- TEFC Welded or Cast Iron Frame
- Multiple Voltages up to 11kV
- Vacuum Pressure Impregnation
- Low Vibration Level <1.8mm/s
- Versatile Extra Mounting Holes
- Winding & Bearing Protection

Applications

- Cement and Chemical Plants
- Metal Processing
- Foundries and Refineries
- Extruders and Shredders
- Chippers and Thrusters

Washdown Motors



56C Stainless Steel

- 1/3-3 HP
- 3600-1800 RPM
- TEFC IP55
- Dual Rated 60/50 Hz
- Service Factor 1.15
- Single and Three Phase (VFD)
- C-Face Footed and Round Body
- Anti-Corrosion 300 Series Steel

Applications

- Food Processing Equipment
- Poultry Processing
- Corrosive Environments
- Bottling Plants
- Car Washes



Premium Efficient TC - Stainless Steel

- 1-30 HP
- 3600-1800 RPM
- NEMA Premium® TEFC IP55
- Dual Rated 60/50 Hz
- Inverter Rated 3:1CT 5:1VT
- Service Factor 1.15
- Vacuum Pressure Impregnation
- Anti-Corrosion 300 Series Steel

Applications

- Food Processing Equipment
- Poultry Processing
- Corrosive Environments
- Bottling Plants
- Car Washes



56C Single & Three Phase

- 1/3-3 HP
- 3600-1800 RPM
- TEFC IP55
- Dual Rated 60/50 Hz
- Service Factor 1.15
- Single and Three Phase
- C-Face Footed and Round Body

Applications

- Gear Reducers
- Machine Tools
- Fans and Blowers
- Compressors
- Grinders
- Conveyors



T/TC - High Torque Single Phase

- 3-10 HP
- 3600-1800 RPM
- TEFC IP55
- Single Phase 60 Hz
- Service Factor 1.15
- High Starting Torque
- Footed and C-Face Footed

Applications

- Grain Augers
- Grain Legs
- Bucket Elevators
- Feeders
- Agitators
- Irrigation Pumps