

LOAD CELLS**shear beam****PS8D**

Stainless steel beam load cell
Hermetically sealed IP68
Suitable for platform, hopper and pallet scales
High accuracy up to 6000 division approved
Wide range of capacities

TECHNICAL CHARACTERISTICS PS8D

Rated load (R.L.):	150, 300, 500, 1000, 1500, 2000, 2500, 3000, 5000 KG
Combined error:	$\pm 0.023\%$ R.O. (C3); $\pm 0.0175\%$ R.O. (C4)
Safe overload:	150% of R.L.
Ultimate overload:	300% of R.L.
Zero balance:	$< \pm 1.0\%$ FS
Recommended input:	5 ÷ 12 Vdc/Vac
Input resistance:	350 \pm 3.5 Ohms
Output resistance:	350 \pm 3.5 Ohms
Insulation resistance:	> 5000 M Ohms
Compensated temperature range:	-10 ÷ +40 °C
Temperature range:	-35 / +65°C
Material:	Stainless steel
Degree of protection:	IP68



150kg – 300kg (Bending)

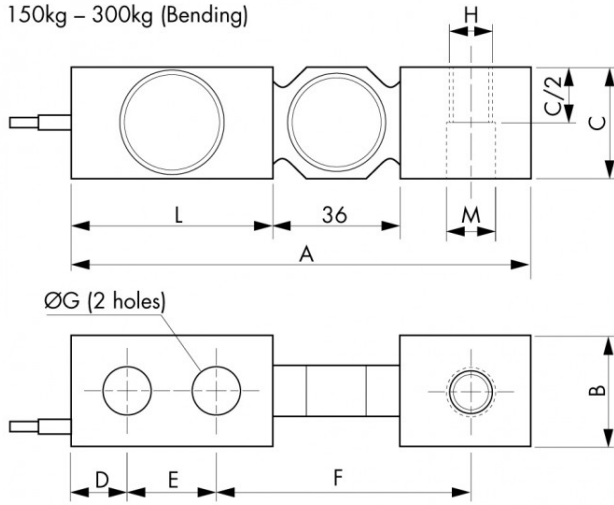

Other capacities (Shear)

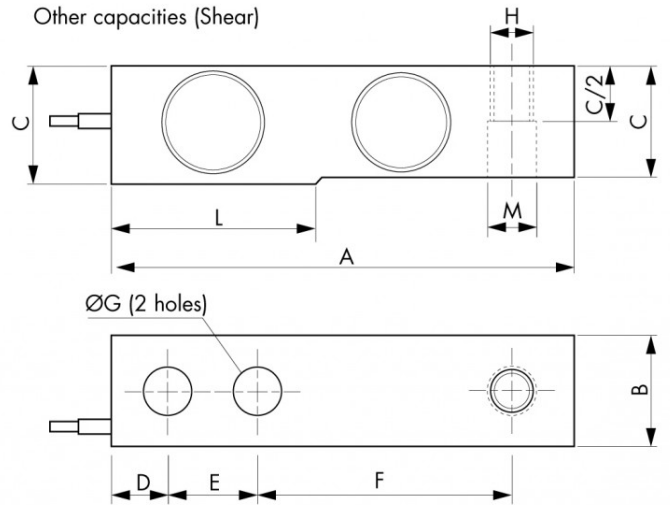

Electrical Connections	
+Excitation	Red
-Excitation	Black
+Sense	Brown
-Sense	Yellow
+Signal	Blue
-Signal	White
Shield	Cable Shield
* Sense when available	

Capacity Kg	150-300	500-2000	2500-5000
A	130	130	171
B	31.3	31.3	36.8
C	31.3	31.3	36.8
c	-	*see note	34.8
D	15.7	15.7	19
E	25.4	25.4	38.1
F	76.2	76.2	95.2
G	13.5	13.5	20.5
H	M12x1.75	M12x1.75	M20x2.5
L	57.1	57.1	76.2
M	13.5	13.5	20.5
*Note: 500kg 24.8; 1000kg 26.0; 2000kg 28.0			

