



**SANKYO**  
**AUTOMATION**



Precision. Quality. Reliability.

Alpha Series (AD)

Rotary Indexing Tables

# Sankyo Alpha Series (AD) Rotary Indexing Tables



## Sankyo's Alpha Series (AD)

Sankyo is the worldwide leader in indexing technology and continues to develop innovation in motion control. Sankyo's core indexing system is based upon the roller gear cam mechanism, a simple combination of a globoidal cam and cam followers in a precision machined turret. The profile of the cam, and the rolling contact surfaces of the cam followers produce a perfectly smooth, controlled motion. This results in Sankyo's Alpha Series (AD) rotary indexing tables capable of producing;

- greater output torque for higher inertia loads,
- faster indexing speeds with no backlash,
- and unmatched positioning accuracies!

## Warranty

Due to the outstanding field performance of units sold to date, Sankyo is pleased to announce that the warranty period for all its new Alpha (AD) units sold are extended to (4) years. Each unit will be filled before shipment with **MobilSHC** series synthetic gear oil, thus making our units "filled for life/maintenance free" vs. our competitor's units like those whose designs utilizes a cogged drive belt and lesser quality oils.

## Service

All Sankyo Alpha Series (AD) units sold in North America are assembled and can be fully serviced from our location in Sidney, Ohio.

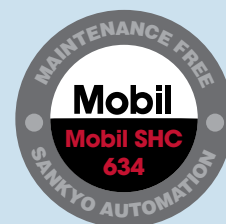

# Alpha Series (AD)

## General Features

- Wider selection of sizes, number of stops, and indexing periods than any other manufacturer
- Shaft center distances available: 70 to 450 mm
- Standard stationary flange with hollow bore: 17 to 120 mm bore diameter
- Table diameters: 100 to 640 mm
- Supports customer dial sizes: 100 to 4,000 mm (4" to 160")

## Construction Features

- Preloaded roller gear cam and cam followers with zero-backlash for superb accuracy and extremely quick settling time
- Precision machined steel cam and turret for unmatched accuracy
- Output table supported by upper and lower preloaded tapered roller bearings for increased stiffness and load capacity
- Industry's largest diameter cam followers to survive extreme loading/crash scenarios and for increased service life
- Durable cast iron housing instead of aluminum for more dimensional stability in changing temperatures and better damping characteristics
- High precision, matched-set needle roller cam followers for smooth motion and no change in accuracy even after many years of continuous operation

## Available Configurations

OUTPUT STOPS	Index Period								
	90°	120°	150°	180°	210°	240°	270°	300°	330°
2									X
3							X	X	X
4							X	X	X
5				X	X	X	X	X	X
6	X**	X	X	X	X	X	X	X	X
8	X	X	X	X	X	X	X	X	X
10	X	X	X	X	X	X	X	X	X
12	X	X	X	X	X	X	X	X	X
16	X	X	X	X	X	X	X	X	X
20***	X	X	X	X	X	X	X	X	X
24***	X	X	X	X	X	X	X	X	X
32***	X	X	X	X	X	X	X	X	X

\* Please contact Sankyo for special output stops not listed above.

X Available Models

\*\* 7AD, 9AD minute index period for 6 stop is 110°, all other sizes 90°

\*\*\* (2) dial positions

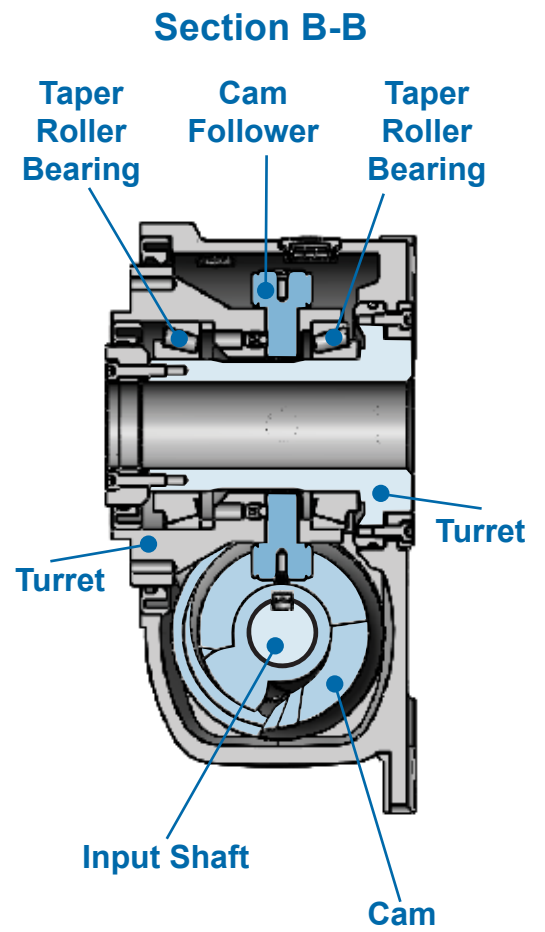
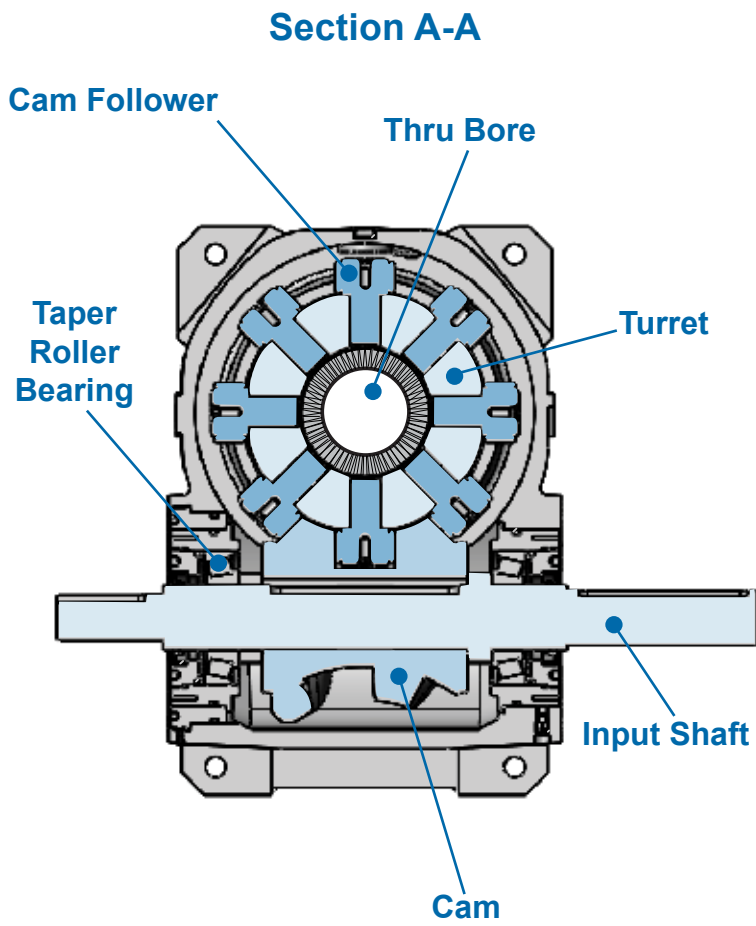
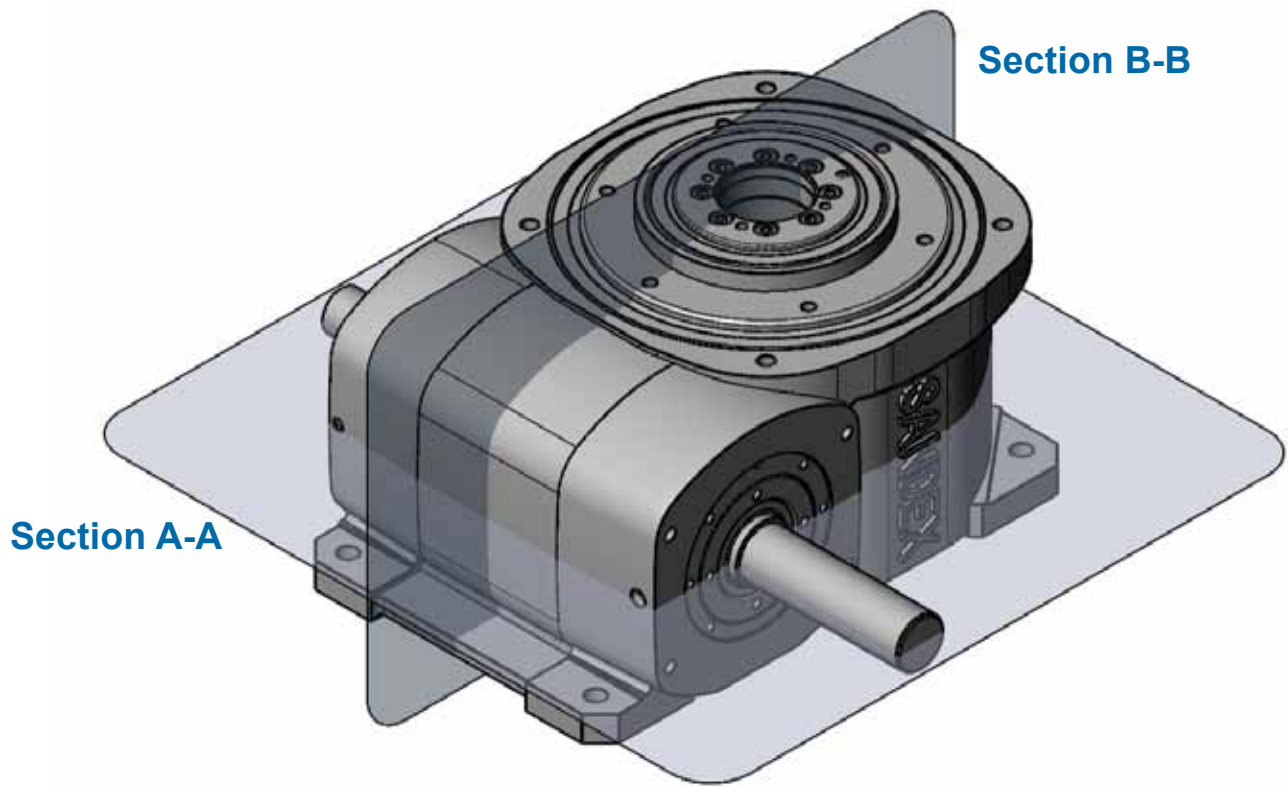

# 7AD Specifications



Typical Dial Size	25" (630 mm)
Available Stops	2,3,4,5,6,8,10,12,15,16,20,24,32
Indexes per minute	200 ipm max depending on loads
Indexing Accuracy (2-16 stop)	+/-30 arc seconds
Repetitive Accuracy	+/-10 arc seconds
Allowable Axial Load	1,660 lbs. (7,390 N)
Allowable Radial Load	590 lbs. (2,630 N)
Allowable Bending Moment	2,300 in*lbs (260 N*m)
Bending Moment Rigidity	2.0E+06 in*lbs/rad (2.3E+05 N*m/rad)
Drive motor sizes	1/8 and 1/4 HP (0.1 and 0.2 kW)
Voltage	230/460 3ph 60Hz (other voltages available)
Product Weight without motor	33 lbs (15 kg)

## Load Capacity (inertia vs. time)

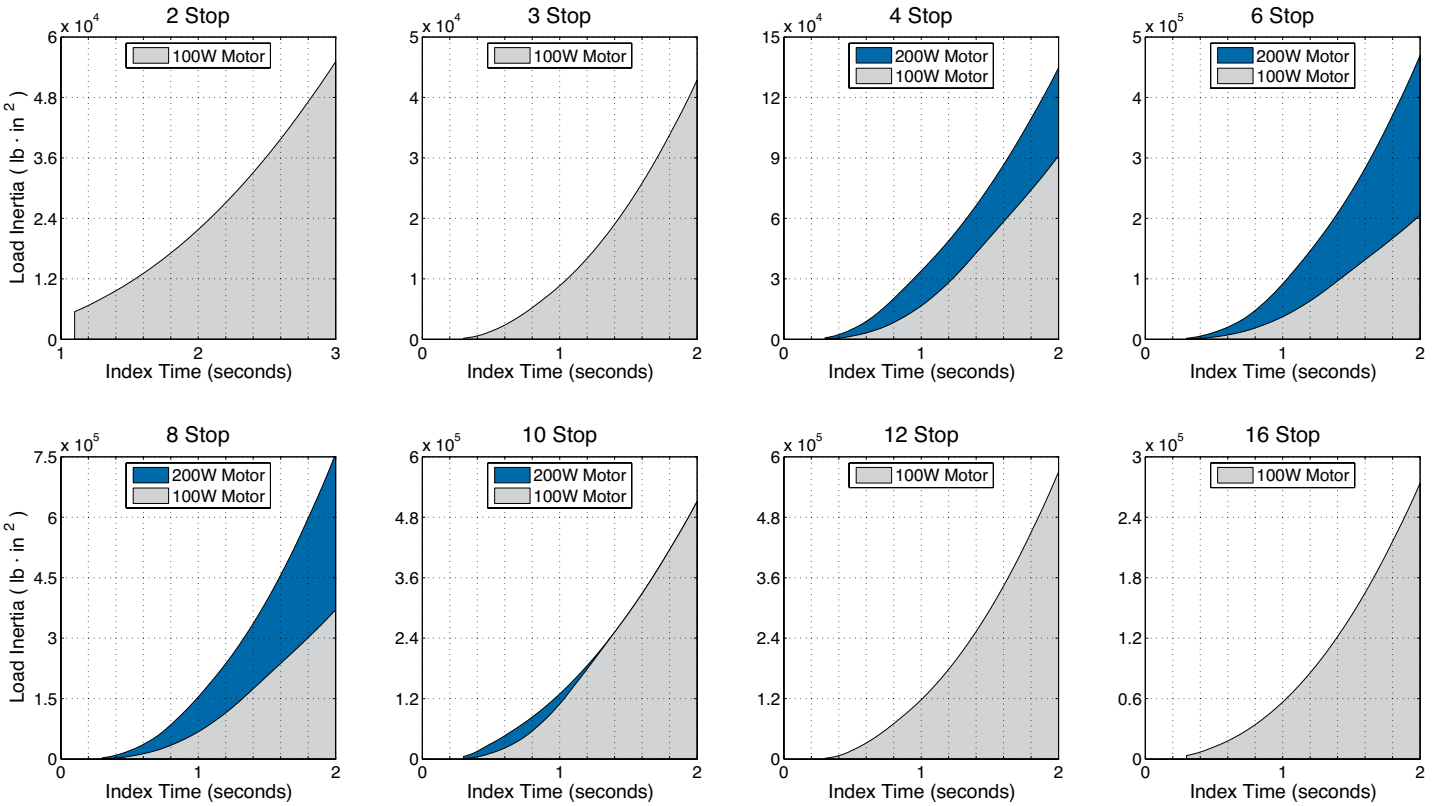

## Load Data

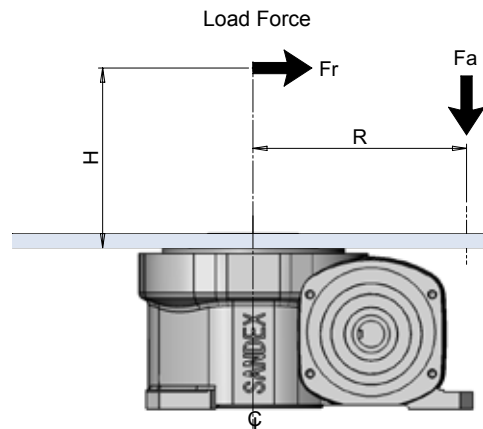
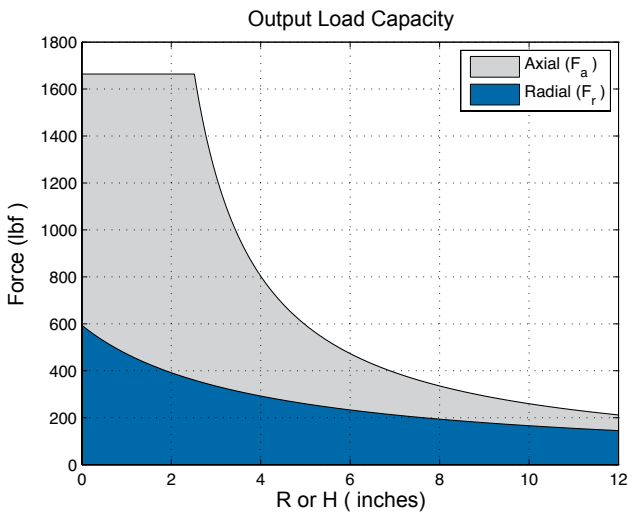

NOTE: Loads are for unidirectional loading only; for combined loading please contact Sankyo.

## 0.1kW Motor

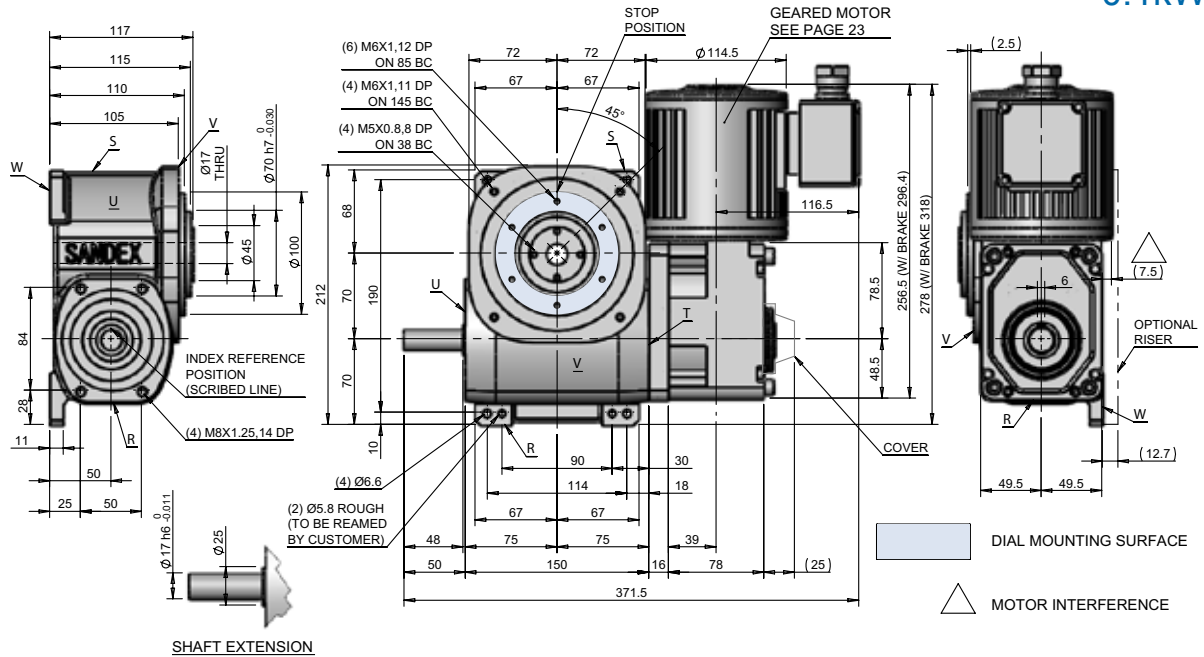

NOTE: ALL DIMENSIONS IN MM

## 0.2kW Motor

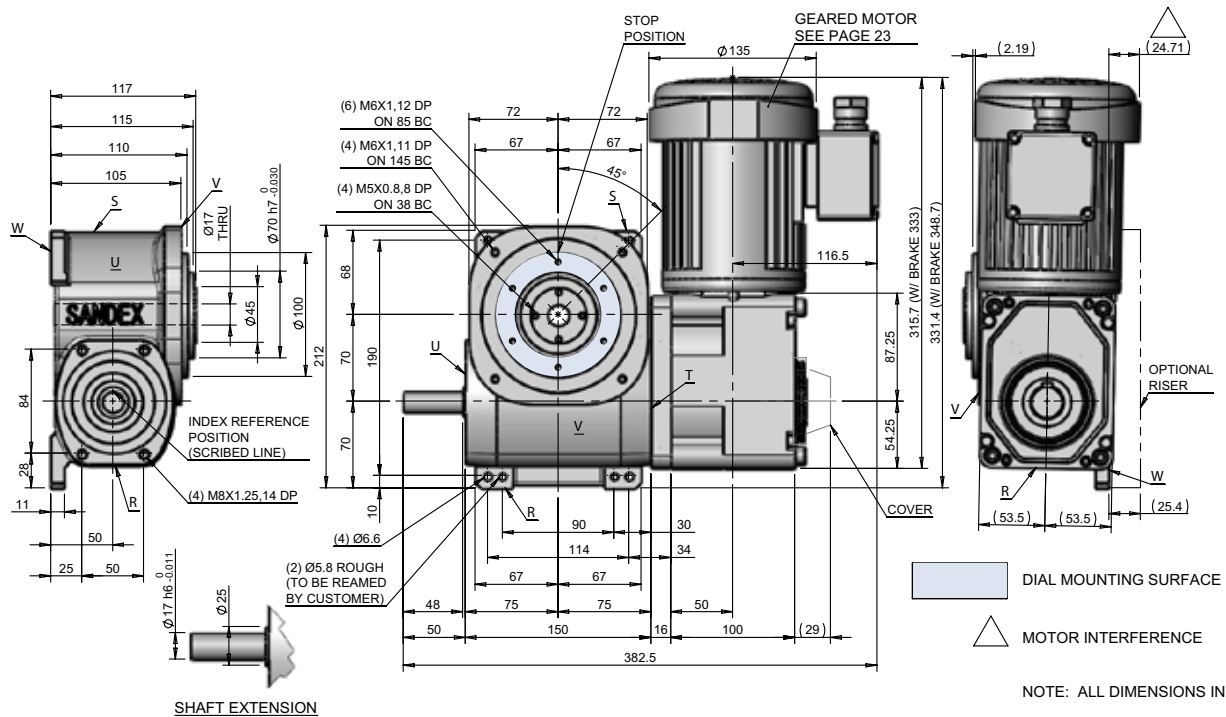

NOTE: ALL DIMENSIONS IN MM

Standard Input Shaft (T surface side)

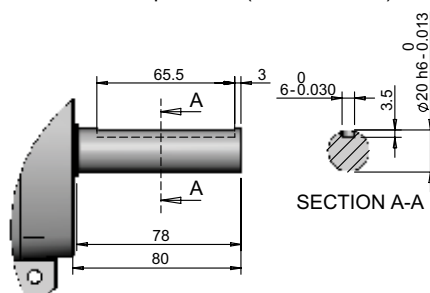

Output Fixed Flange Specifications

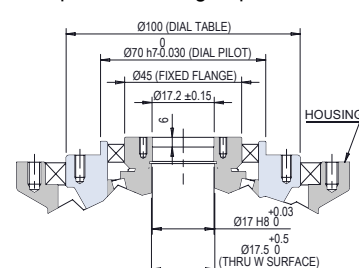

# 9AD Specifications



Typical Dial Size	32" (810 mm)
Available Stops	2,3,4,5,6,8,10,12,15,16,20,24,32
Indexes per minute	200 ipm max depending on loads
Indexing Accuracy (2-16 stop)	+/-25 arc seconds
Repetitive Accuracy	+/-10 arc seconds
Allowable Axial Load	3,120 lbs (13,880 N)
Allowable Radial Load	845 lbs (3,760 N)
Allowable Bending Moment	3,890 in*lbs (440 N*m)
Bending Moment Rigidity	4.0E+06 in*lbs/rad (4.5E+05 N*m/rad)
Drive motor sizes	1/4 and 1/2 HP (0.2 and 0.4 kW)
Voltage	230/460 3ph 60Hz (other voltages available)
Product Weight without motor	53 lbs (24 kg)

## Load Capacity (inertia vs. time)

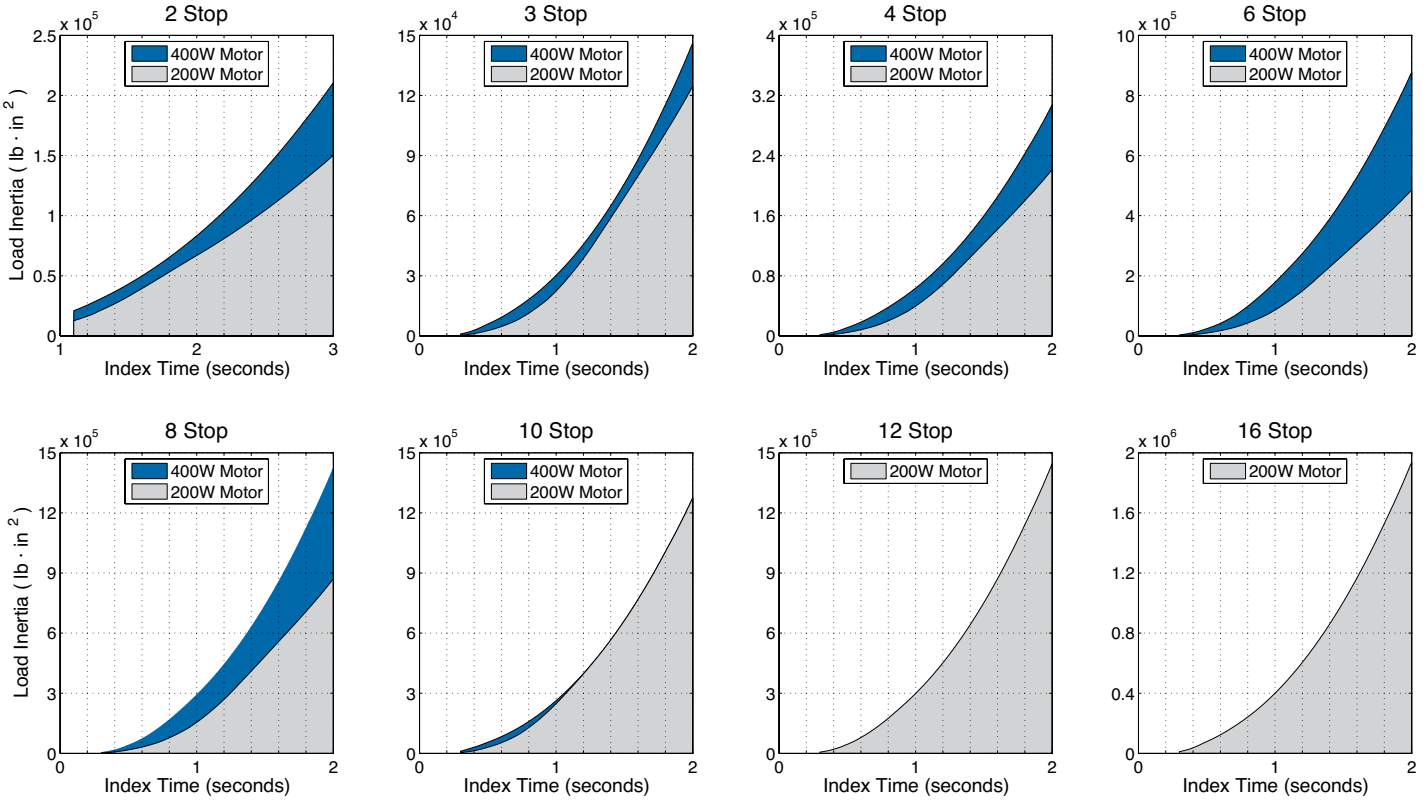

## Load Data

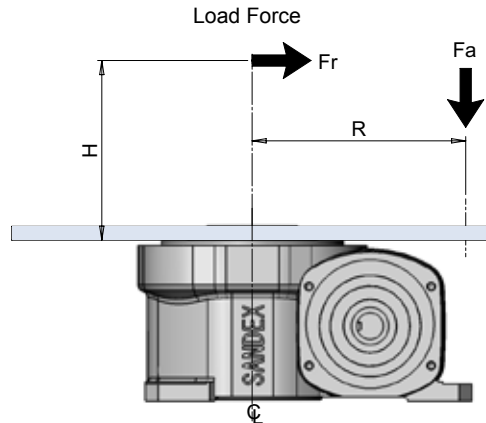
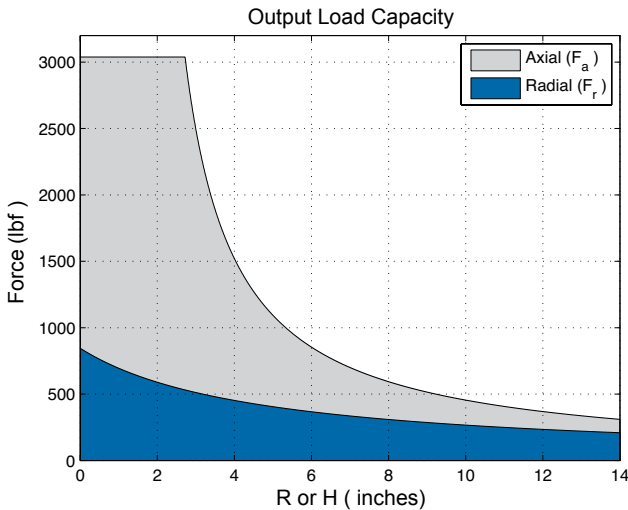

NOTE: Loads are for unidirectional loading only; for combined loading please contact Sanyo.



## 0.2kW Motor

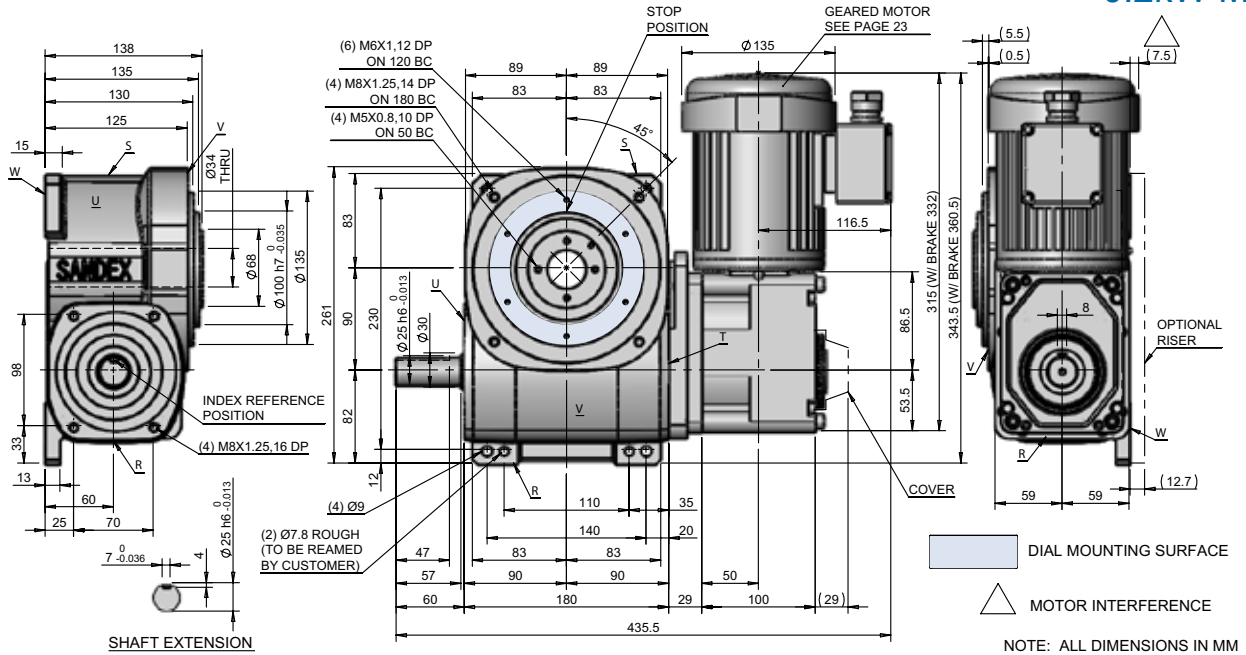

## 0.4kW Motor

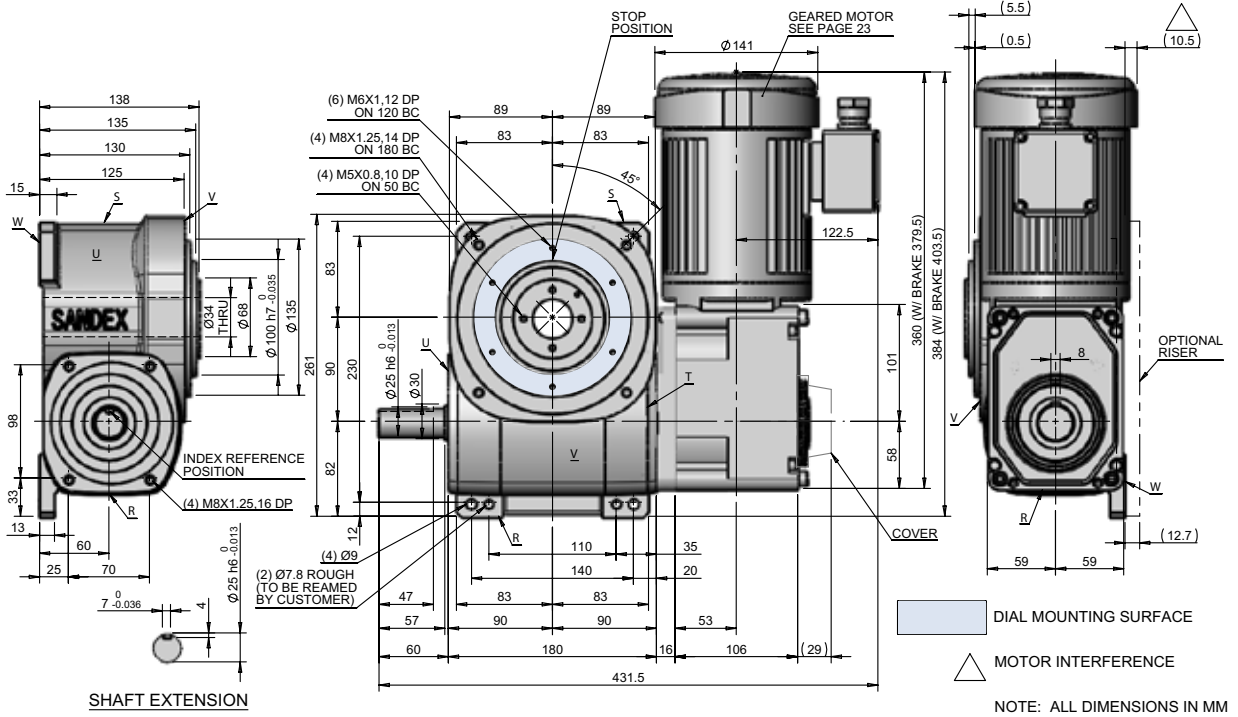

Standard Input Shaft (T surface side)

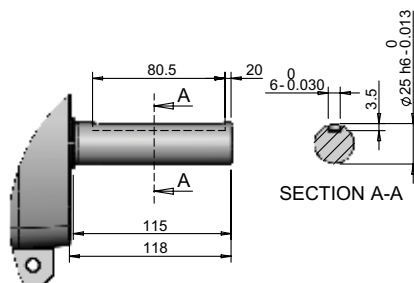

Output Fixed Flange Specifications

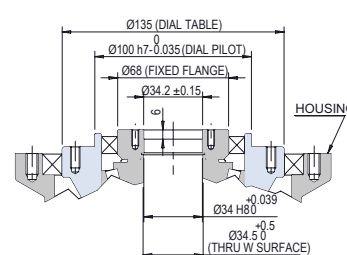

# 11AD Specifications



Typical Dial Size	40" (1,000 mm)
Available Stops	2,3,4,5,6,8,10,12,15,16,20,24,32
Indexes per minute	200 ipm max depending on loads
Indexing Accuracy (2-16 stop)	+/-20 arc seconds
Repetitive Accuracy	+/-10 arc seconds
Allowable Axial Load	4,150 lbs (18,470 N)
Allowable Radial Load	1,310 lbs (5,830N)
Allowable Bending Moment	6,950 in*lbs (790 N*m)
Bending Moment Rigidity	6.6E+06 in*lbs/rad (7.5E+05 N*m/rad)
Drive motor sizes	1/2 and 1 HP (0.4 and 0.75 kW)
Voltage	230/460 3ph 60Hz (other voltages available)
Product Weight without motor	93 lbs (42 kg)

## Load Capacity (inertia vs. time)

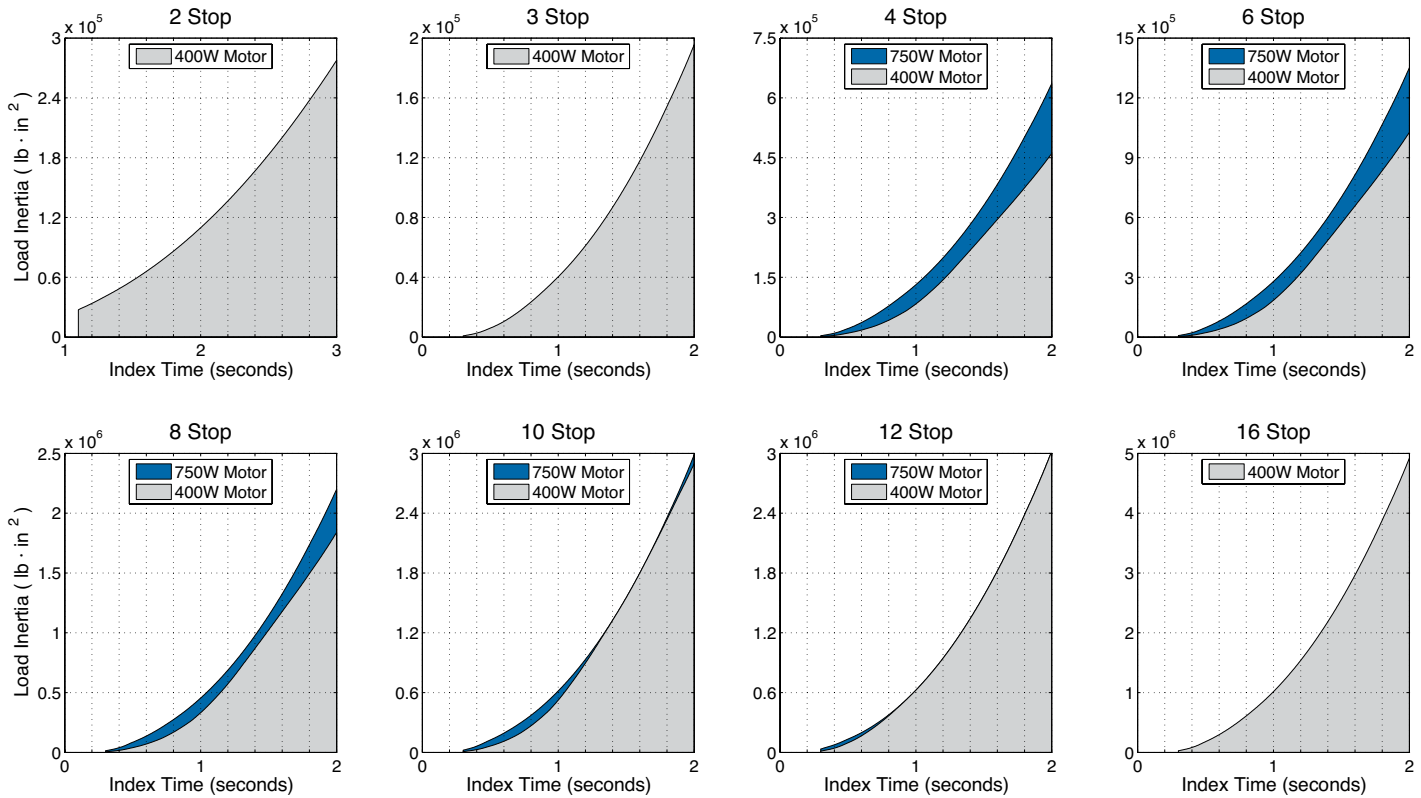

## Load Data

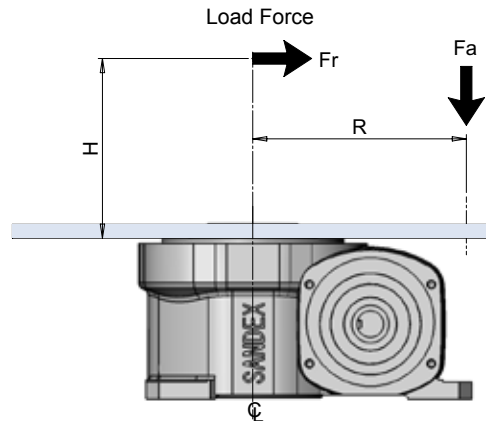
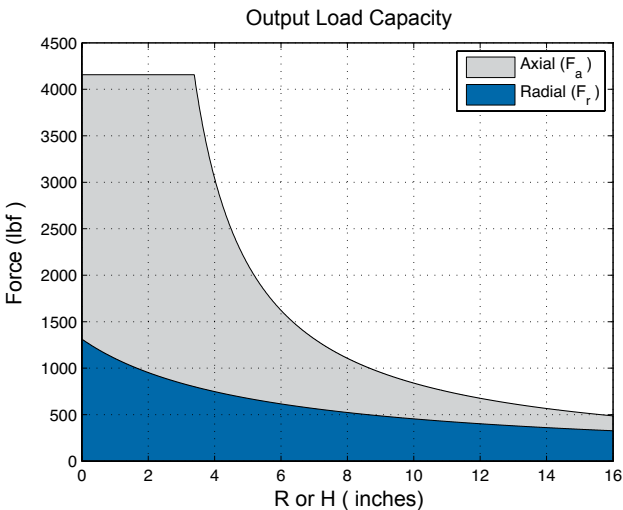

NOTE: Loads are for unidirectional loading only; for combined loading please contact Sanyo.

## 0.4kW Motor

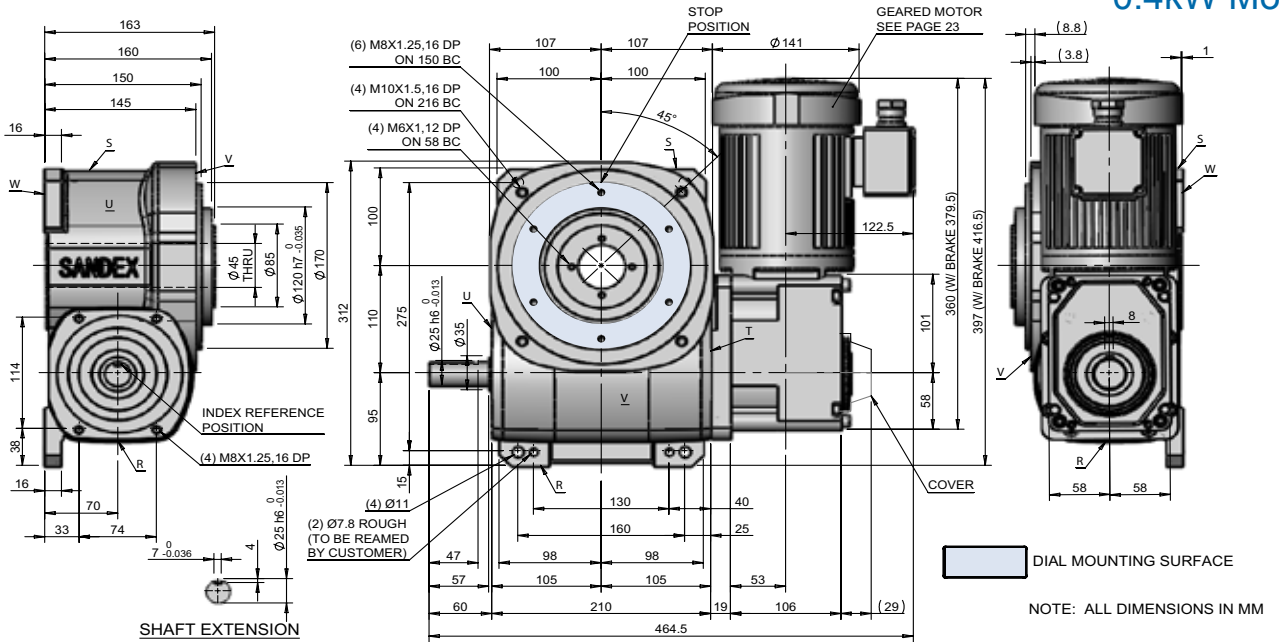

## 0.75kW Motor

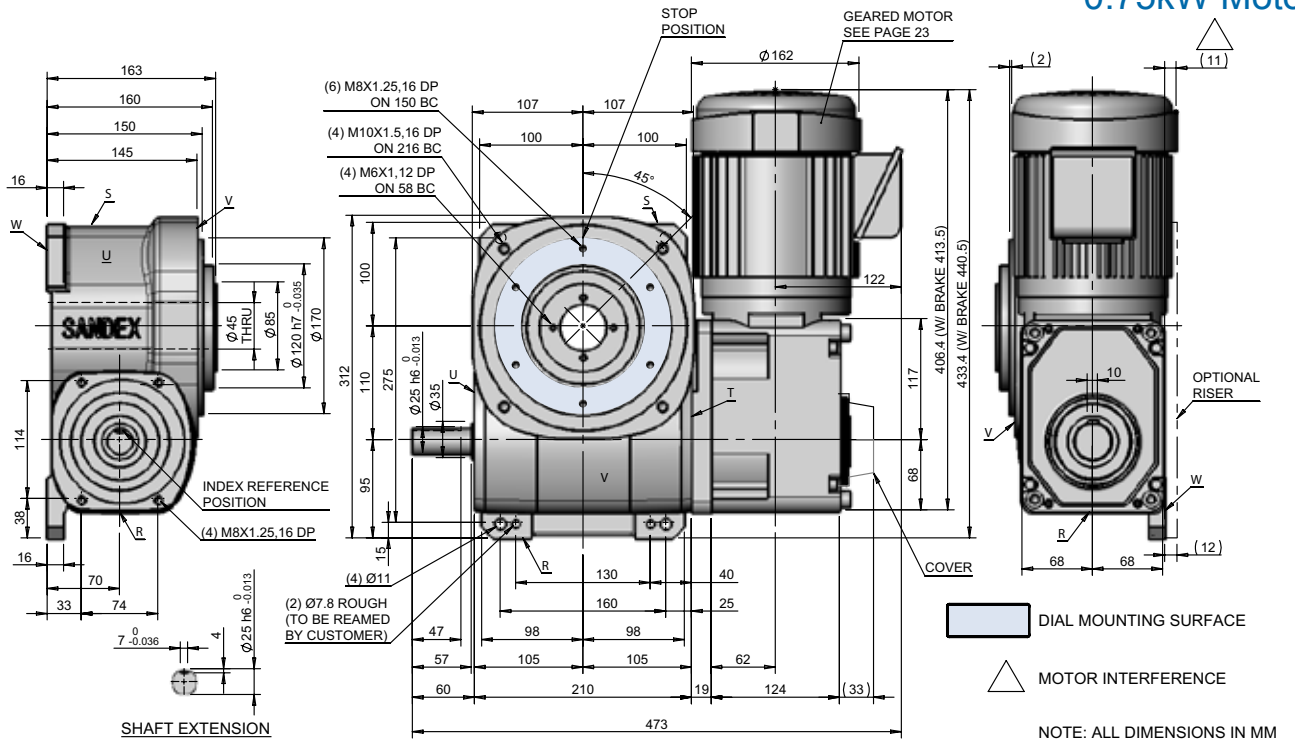

Standard Input Shaft (T surface side)

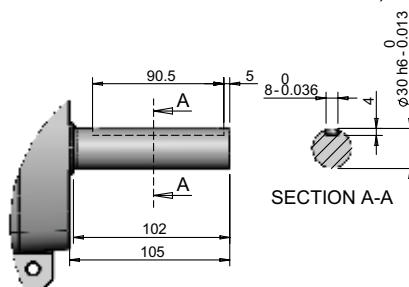

Output Fixed Flange Specifications

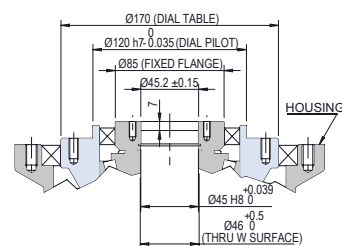

# 15AD Specifications



Typical Dial Size	53" (1,350 mm)
Available Stops	2,3,4,5,6,8,10,12,15,16,20,24,32
Indexes per minute	200 ipm max depending on loads
Indexing Accuracy (2-16 stop)	+/-15 arc seconds
Repetitive Accuracy	+/-7.5 arc seconds
Allowable Axial Load	6,240 lbs (27,770 N)
Allowable Radial Load	2,490 lbs (11,080 N)
Allowable Bending Moment	15,200 in*lbs (1,720 N*m)
Bending Moment Rigidity	1.8E+07 in*lbs/rad (2.0E+06 N*m/rad)
Drive motor sizes	1 and 2 HP (0.75 and 1.5 kW)
Voltage	230/460 3ph 60Hz (other voltages available)
Product Weight without motor	187 lbs (85 kg)

## Load Capacity (inertia vs. time)

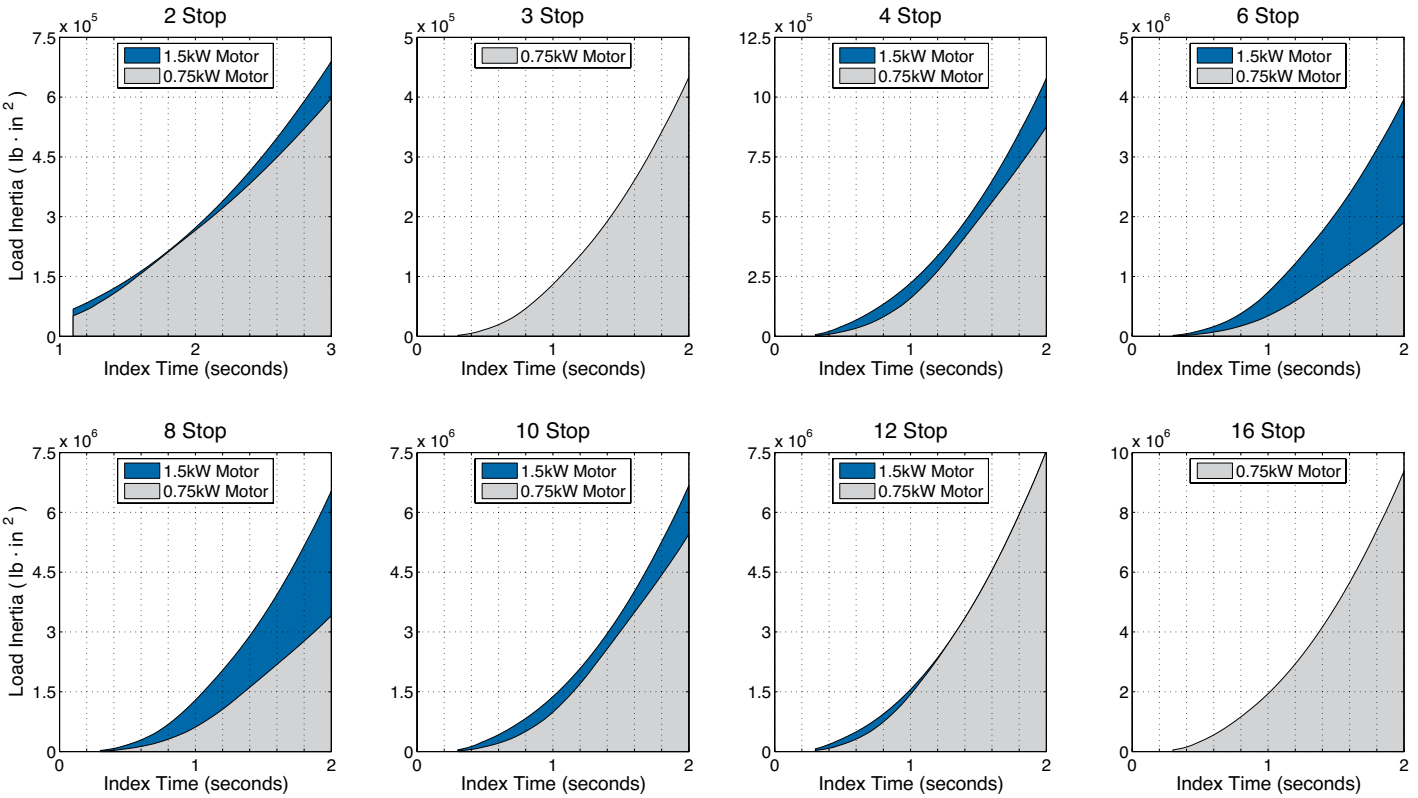

## Load Data

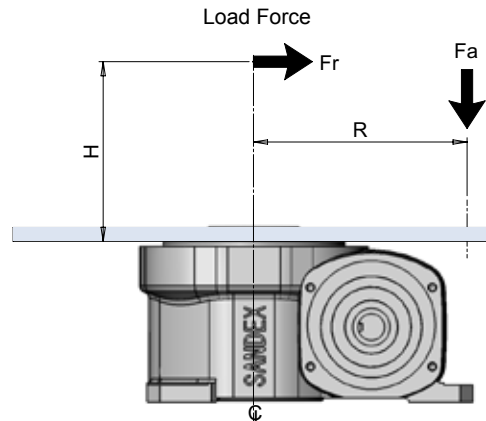
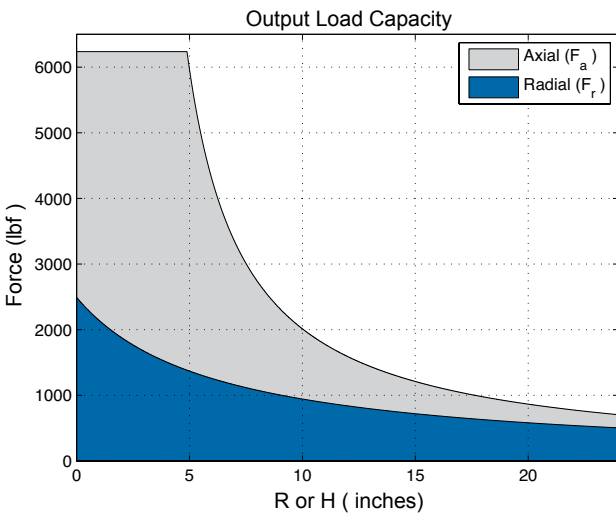

NOTE: Loads are for unidirectional loading only; for combined loading please contact Sankyo.

# 15AD Dimensions

## 0.75kW Motor

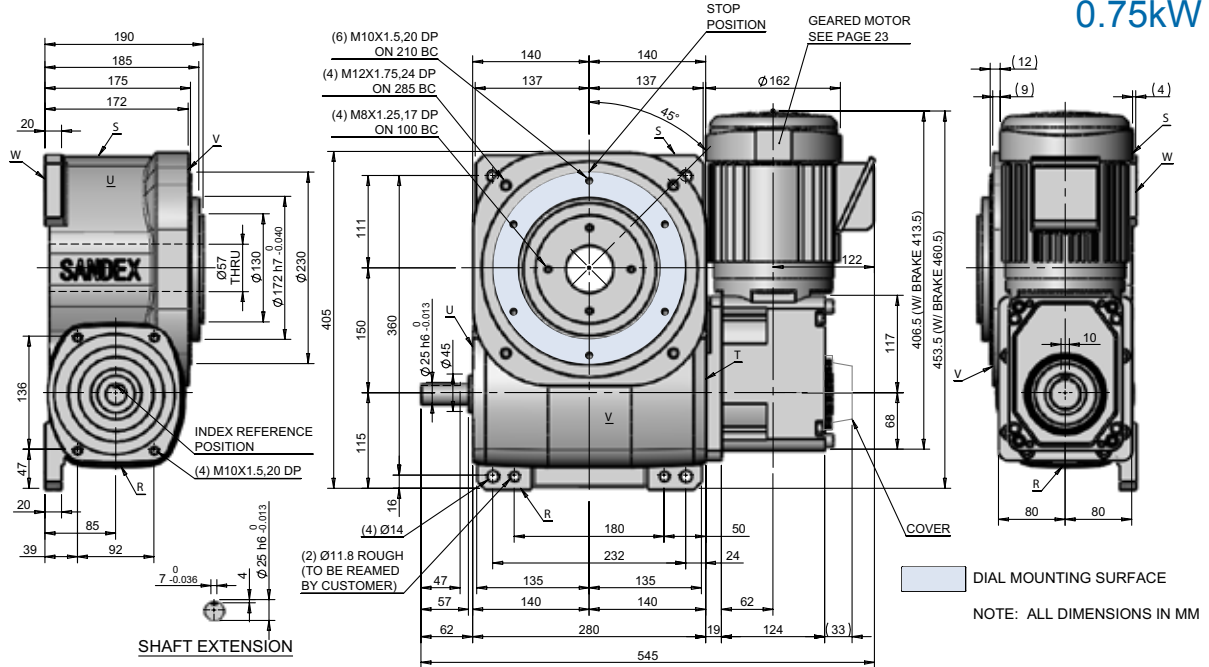

## 1.5kW Motor

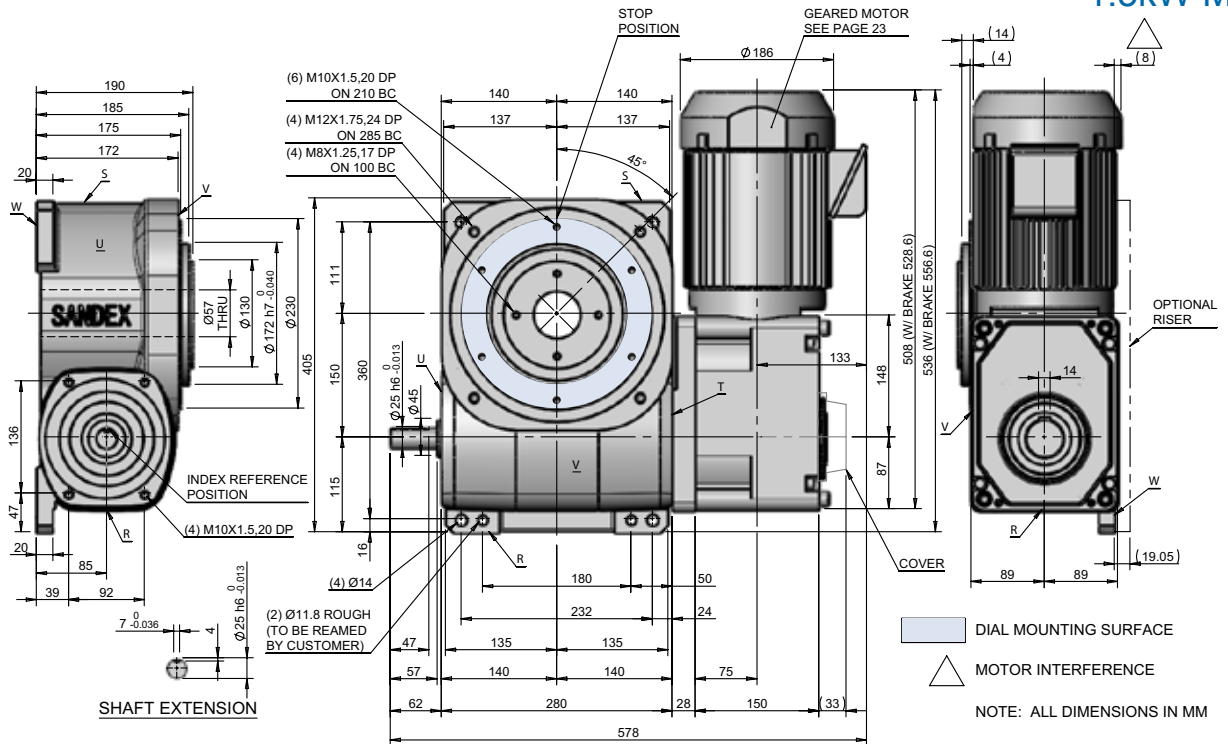

Standard Input Shaft (T surface side)

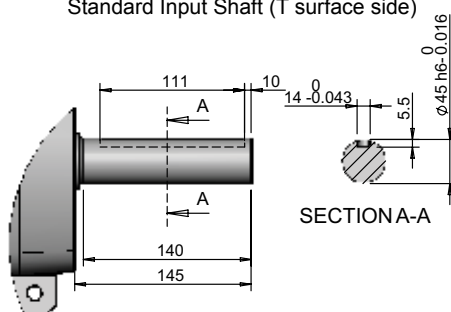

Output Fixed Flange Specifications

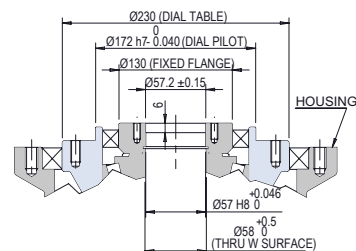

# 19AD Specifications



Typical Dial Size	67" (1,710 mm)
Available Stops	2,3,4,5,6,8,10,12,15,16,20,24,32
Indexes per minute	200 ipm max depending on loads
Indexing Accuracy (2-16 stop)	+/-15 arc seconds
Repetitive Accuracy	+/-7.5 arc seconds
Allowable Axial Load	13,460 lbs (59,890 N)
Allowable Radial Load	3,470 lbs (15,440 N)
Allowable Bending Moment	28,000 in*lbs (3,160 N*m)
Bending Moment Rigidity	5.0E+07 in*lbs/rad (5.7E+06 N*m/rad)
Drive motor sizes	3 and 5 HP (2.2 and 3.7 kW)
Voltage	230/460 3ph 60Hz (other voltages available)
Product Weight without motor	397 lbs (180 kg)

## Load Capacity (inertia vs. time)

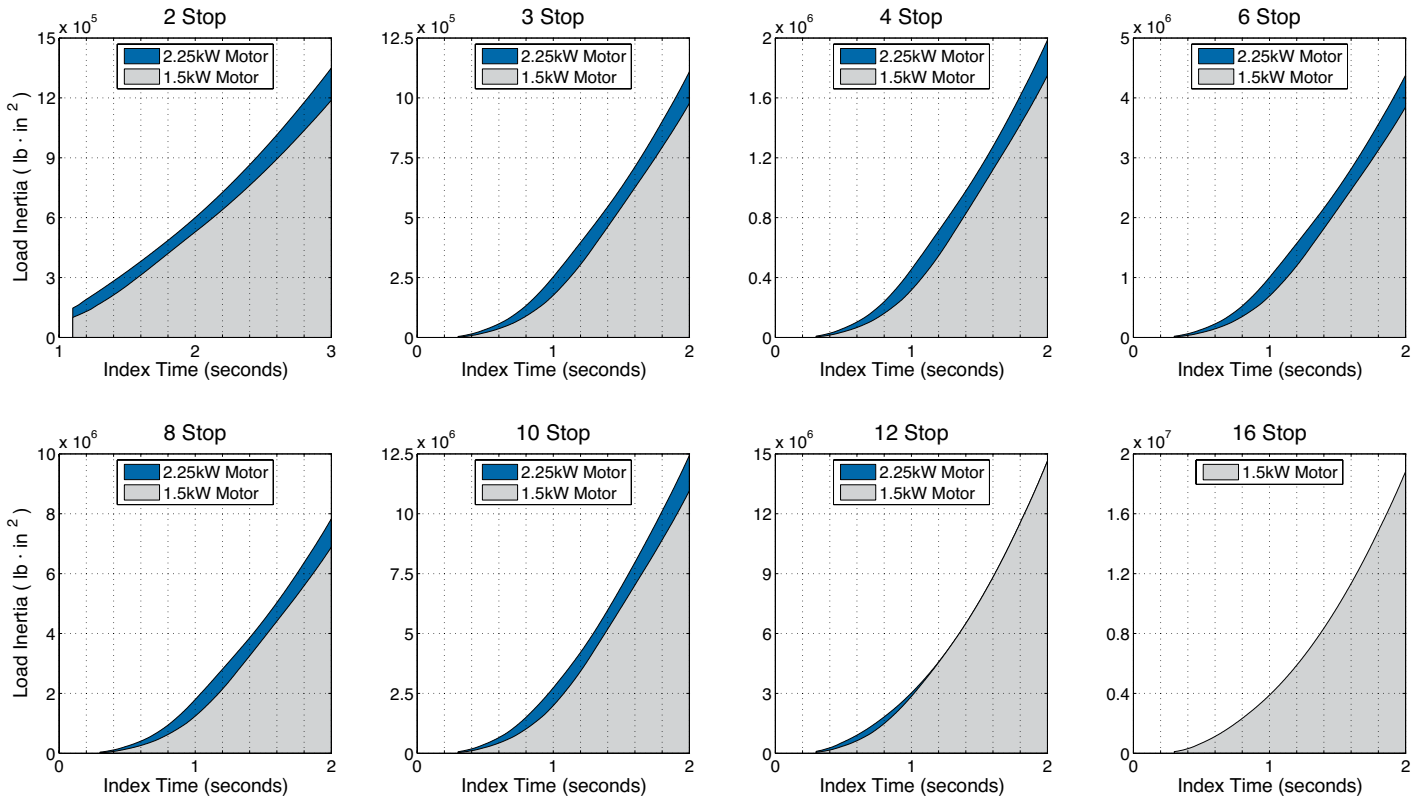

## Load Data

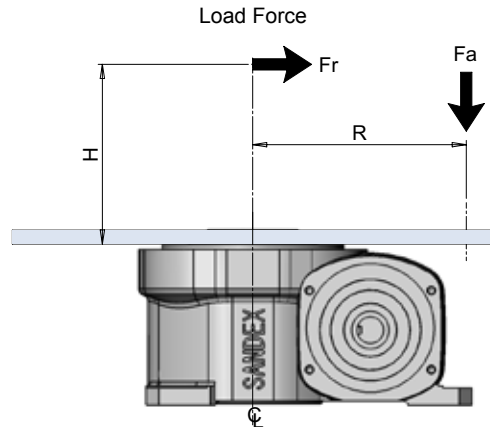
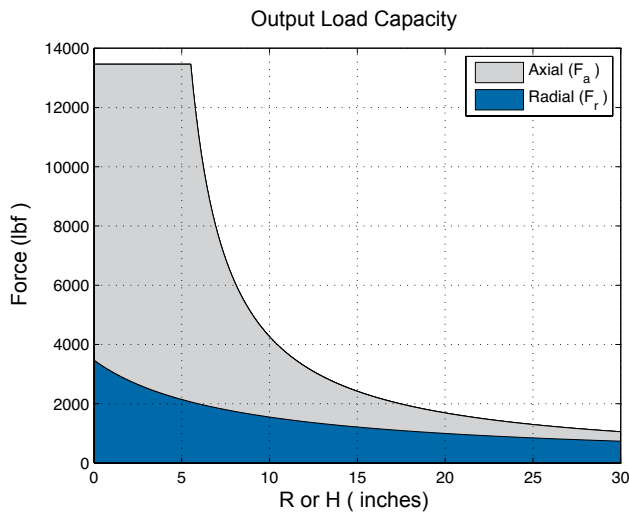

NOTE: Loads are for unidirectional loading only; for combined loading please contact Sankyo.

# 19AD Dimensions

## 1.5kW Motor

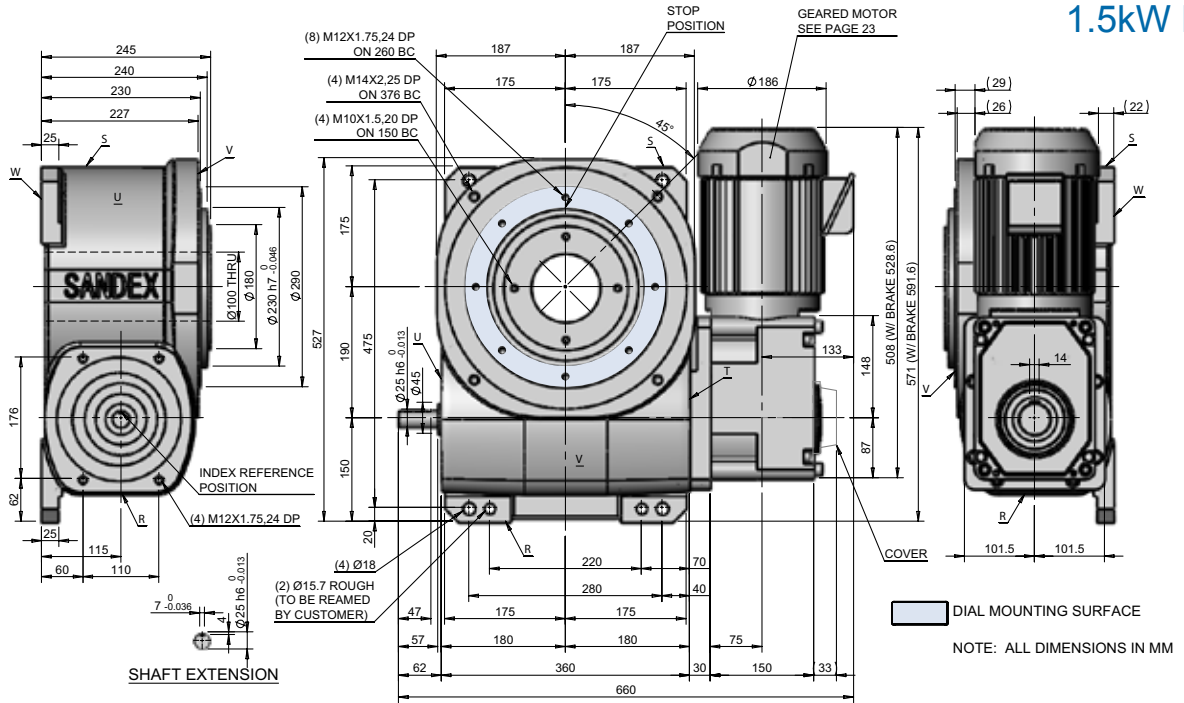

## 2.2kW Motor

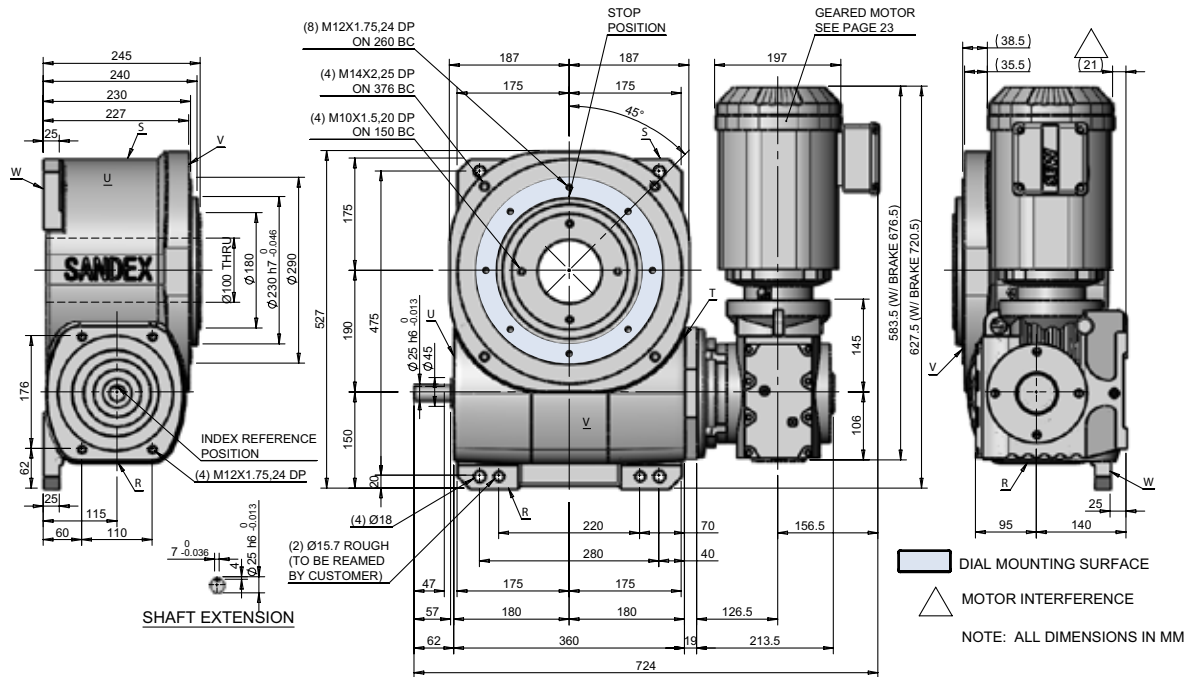

Standard Input Shaft (T surface side)

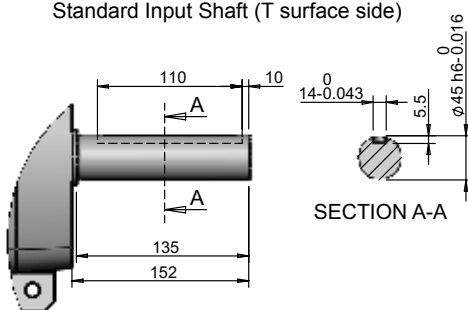

Output Fixed Flange Specifications

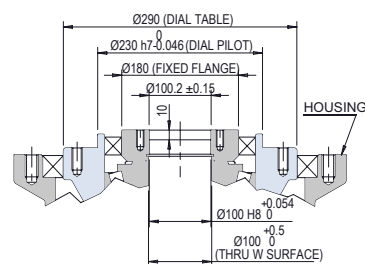

# 23AD Specifications



Typical Dial Size	81" (2,070 mm)
Available Stops	2,3,4,5,6,8,10,12,15,16,20,24,32
Indexes per minute	200 ipm max depending on loads
Indexing Accuracy (2-16 stop)	+/-15 arc seconds
Repetitive Accuracy	+/-7.5 arc seconds
Allowable Axial Load	20,230 lbs (90,020 N)
Allowable Radial Load	4,370 lbs (19,440 N)
Allowable Bending Moment	42,820 in*lbs (4,840 N*m)
Bending Moment Rigidity	7.4E+07 in*lbs/rad (8.4E+06 N*m/rad)
Drive motor sizes	3 and 5 HP (2.2 and 3.7 kW)
Voltage	230/460 3ph 60Hz (other voltages available)
Product Weight without motor	628 lbs (285 kg)

## Load Capacity (inertia vs. time)

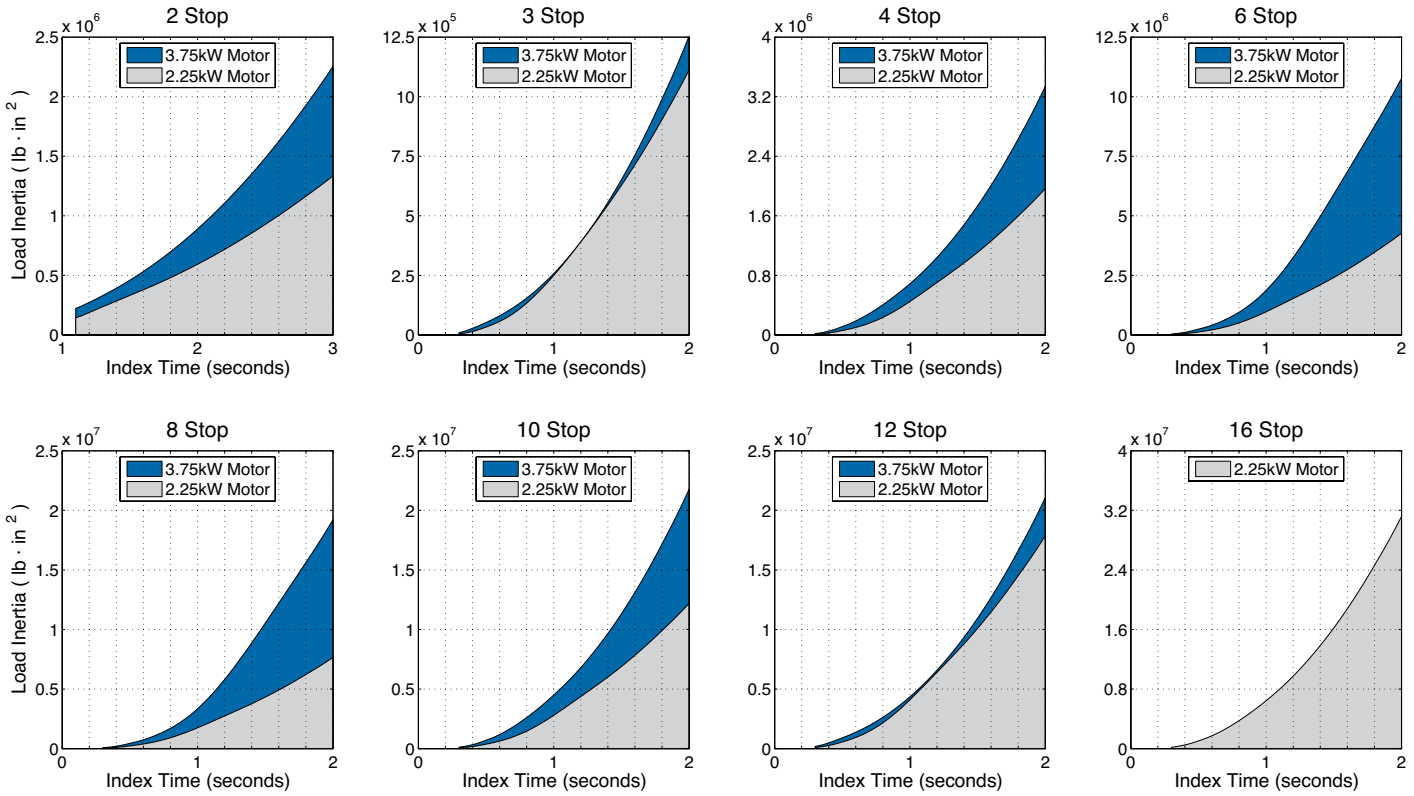

## Load Data

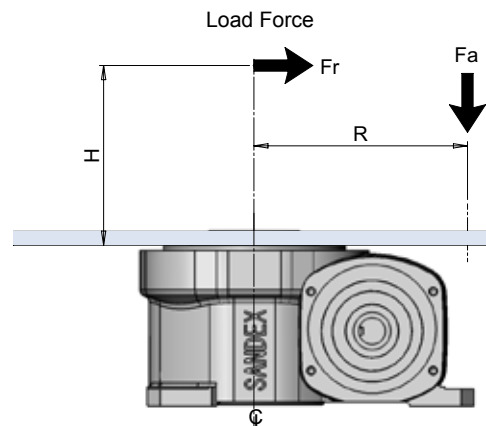
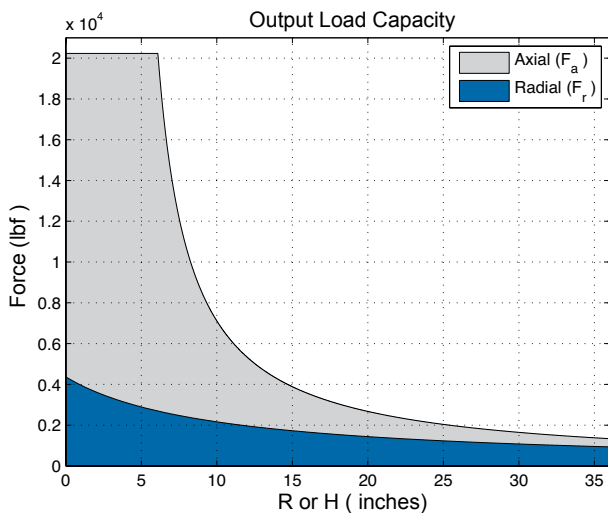

NOTE: Loads are for unidirectional loading only; for combined loading please contact Sankyo.



## 2.2kW Motor

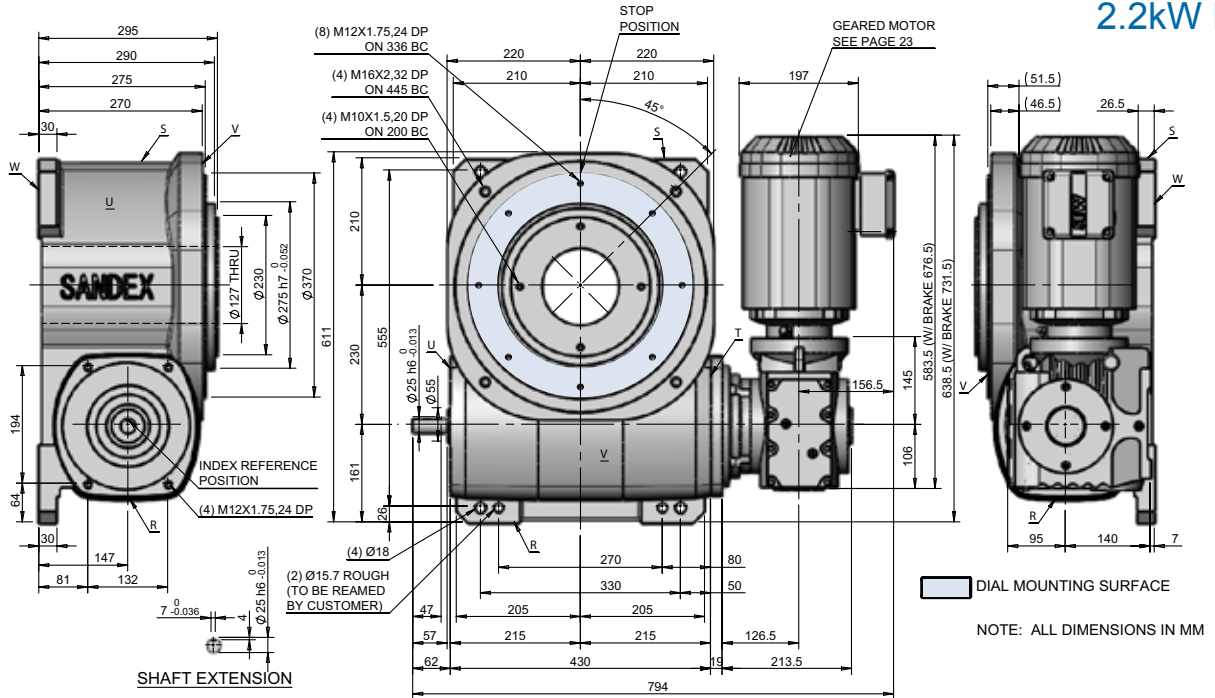

## 3.7kW Motor

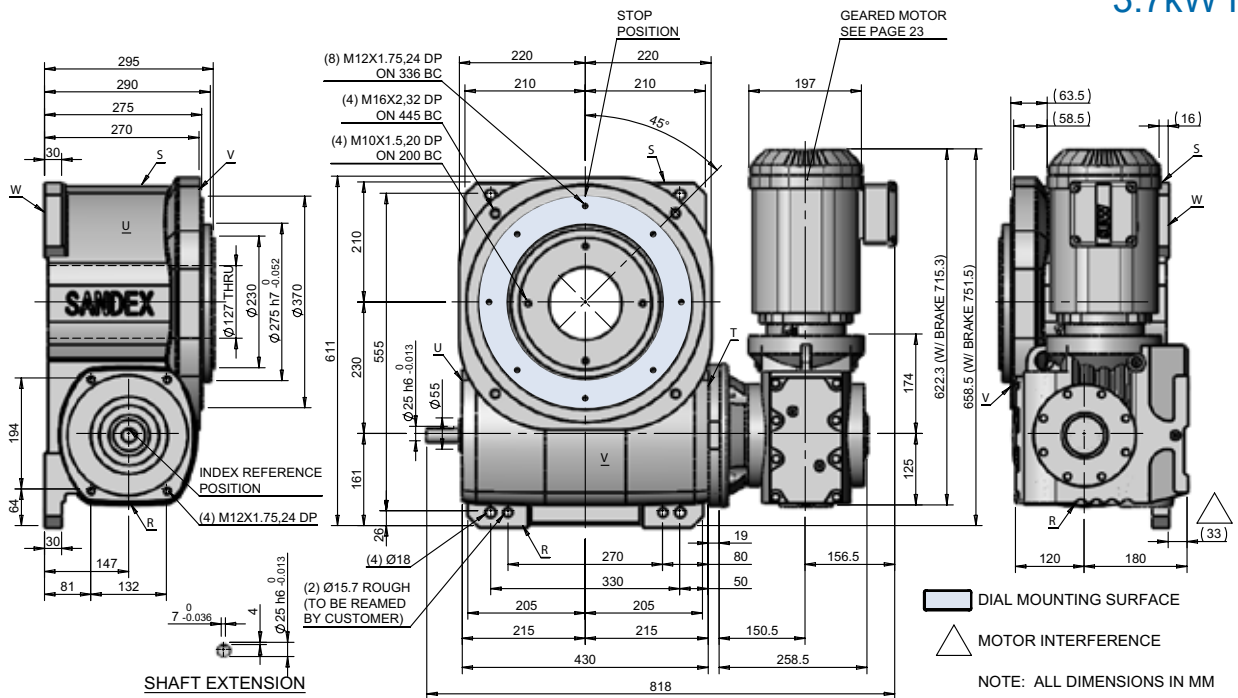

Standard Input Shaft (T surface side)

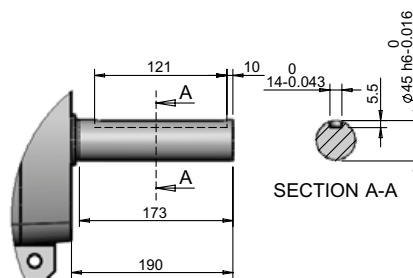

Output Fixed Flange Specifications

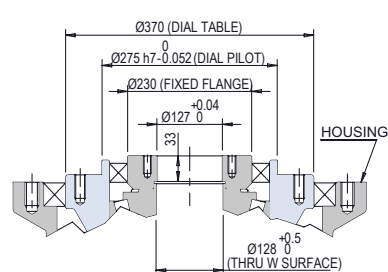

# 33AD Specifications



Typical Dial Size	117" (2,970 mm)
Available Stops	2,3,4,5,6,8,10,12,15,16,20,24,32
Indexes per minute	200 ipm max depending on loads
Indexing Accuracy (2-16 stop)	+/-15 arc seconds
Repetitive Accuracy	+/-7.5 arc seconds
Allowable Axial Load	27,000 lbs (120,140 N)
Allowable Radial Load	5,850lbs (26,030 N)
Allowable Bending Moment	86,300 in*lbs (9,750 N*m)
Bending Moment Rigidity	1.5E+08 in*lbs/rad (1.8E+07 N*m/rad)
Drive motor sizes	7-1/2 and 10 HP (5.5 and 7.5 kW)
Voltage	230/460 3ph 60Hz (other voltages available)
Product Weight without motor	2205 lbs (1000 kg)

## Load Capacity (inertia vs. time)

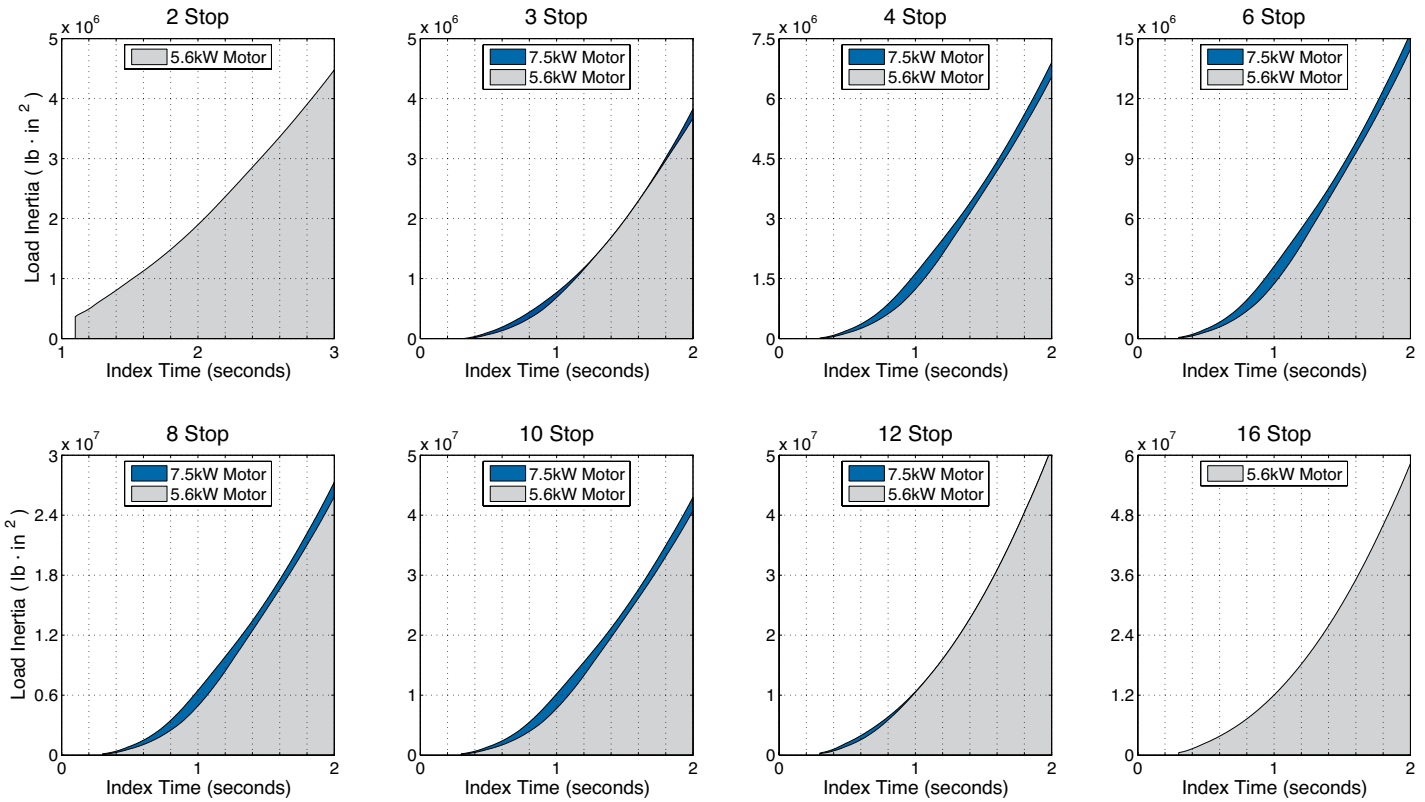

## Load Data

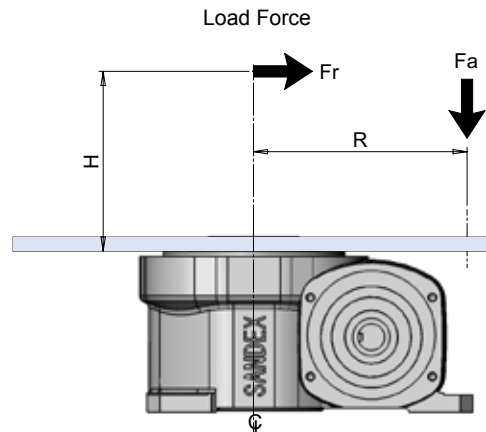
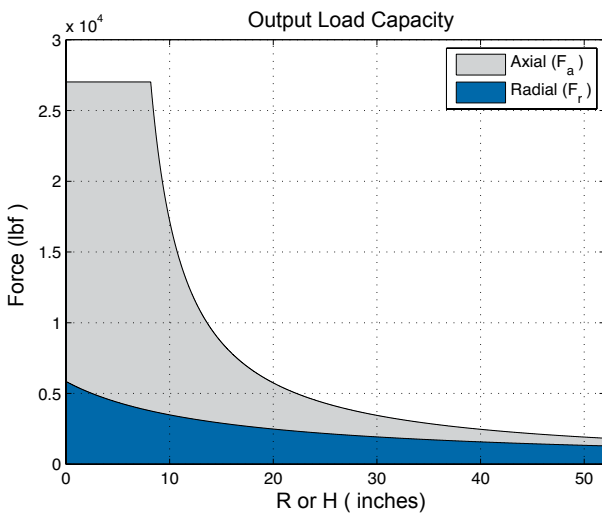

NOTE: Loads are for unidirectional loading only; for combined loading please contact Sanky.

## 5.5kW Motor

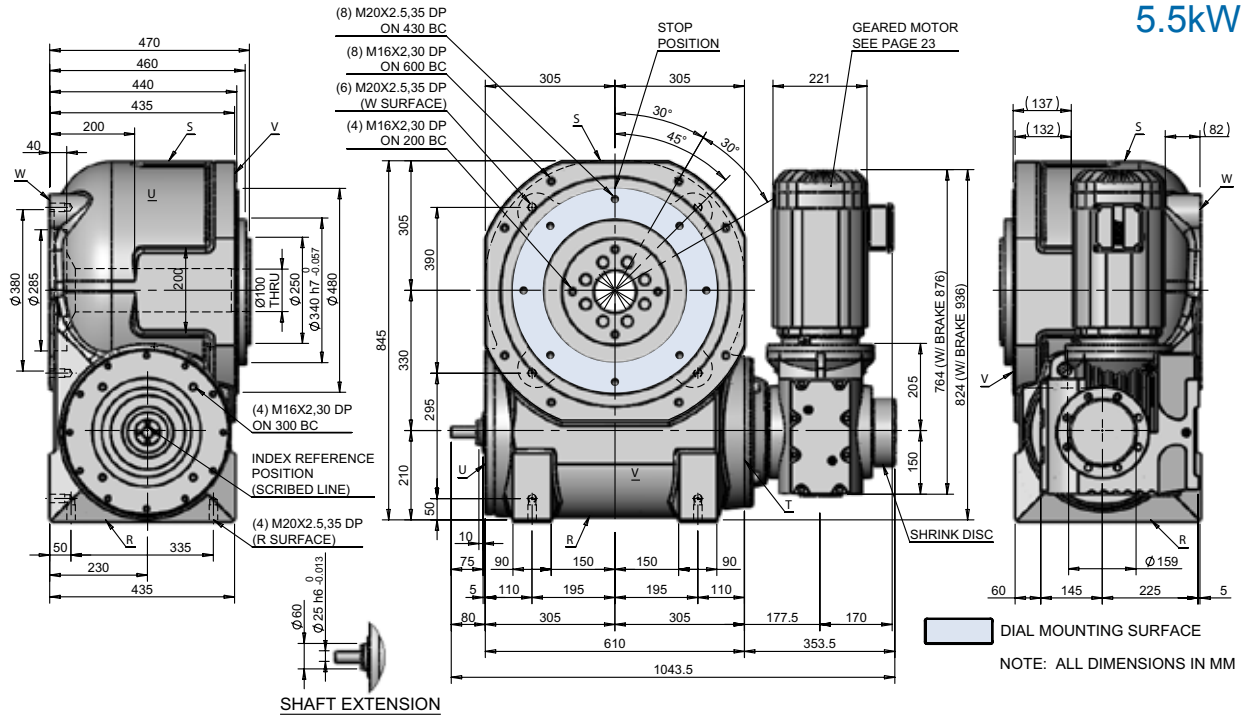

## 7.5kW Motor

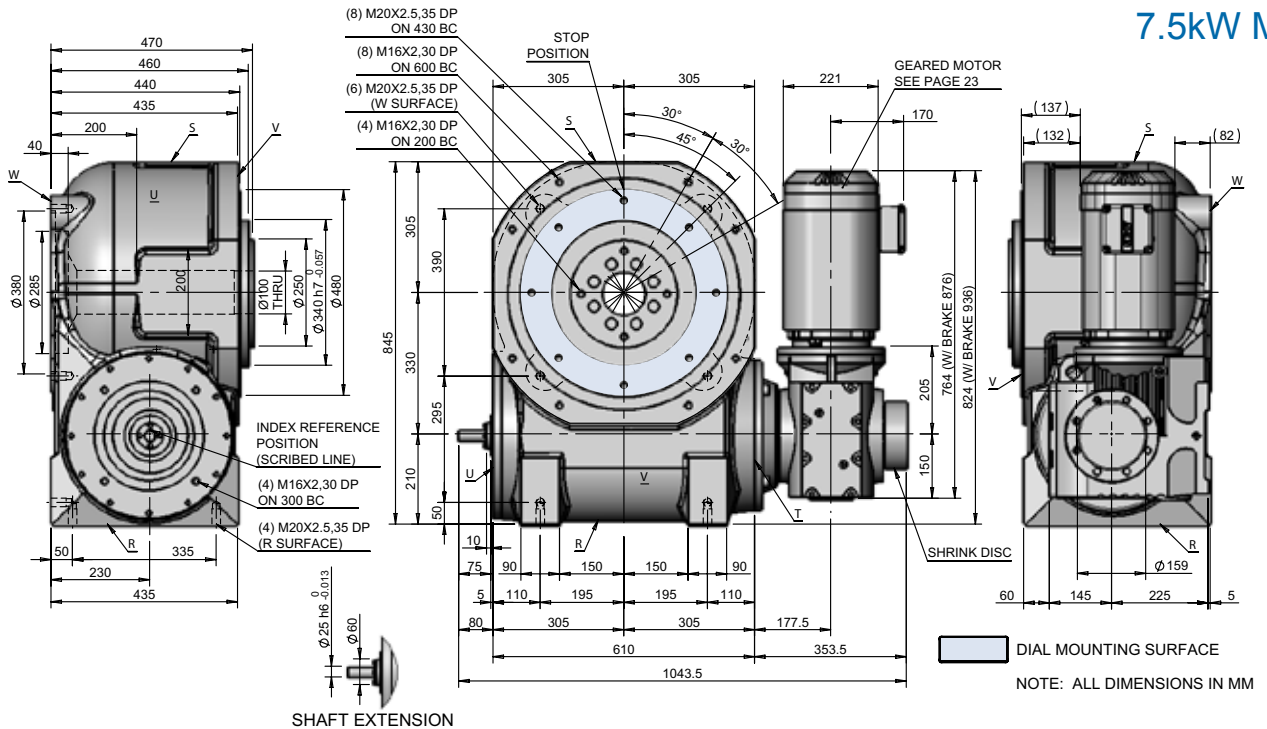

Standard Input Shaft (T surface side)

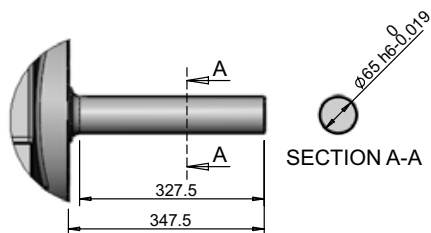

Output Fixed Flange Specifications

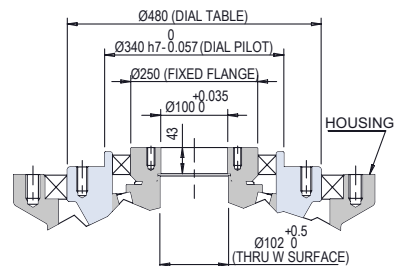

# 45AD Specifications



Typical Dial Size	160" (4,050 mm)
Available Stops	2,3,4,5,6,8,10,12,15,16,20,24,32
Indexes per minute	200 ipm max depending on loads
Indexing Accuracy (2-16 stop)	+/-15 arc seconds
Repetitive Accuracy	+/-7.5 arc seconds
Allowable Axial Load	37,000 lbs (164,640 N)
Allowable Radial Load	8,490 lbs (37,780 N)
Allowable Bending Moment	159,700 in*lbs (18,050 N*m)
Bending Moment Rigidity	2.9E+08 in*lbs/rad (3.3E+07 N*m/rad)
Drive motor sizes	15 and 20 HP (11 and 15 kW)
Voltage	230/460 3ph 60Hz (other voltages available)
Product Weight without motor	3527 lbs (1600 kg)

## Load Capacity (inertia vs. time)

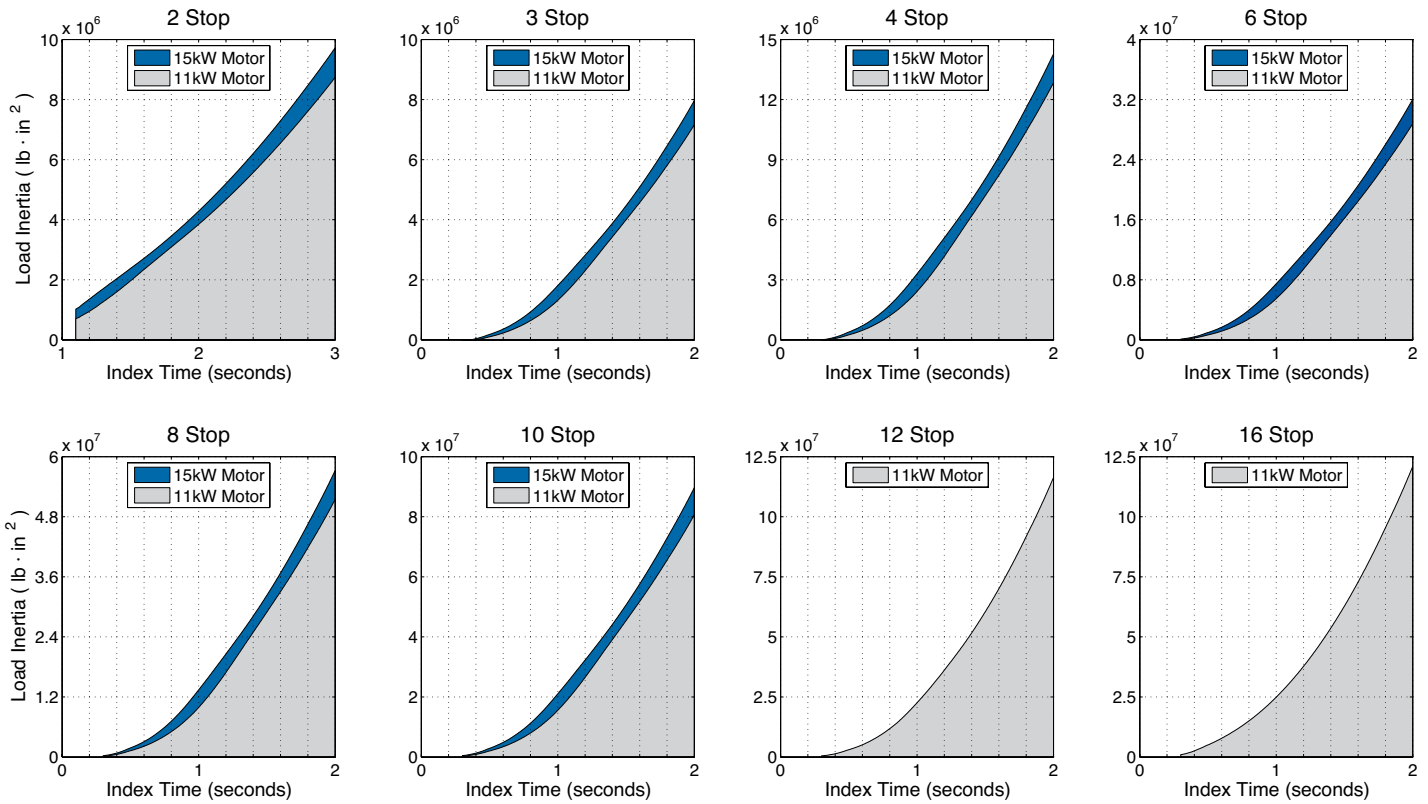

## Load Data

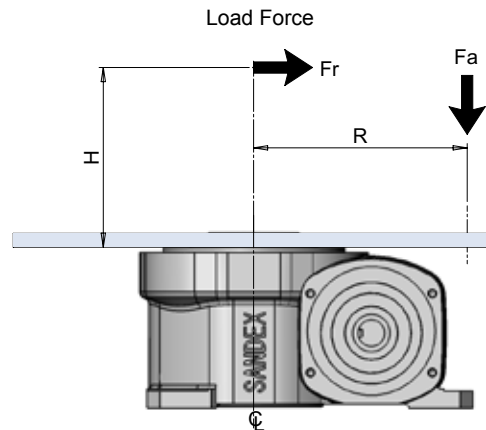
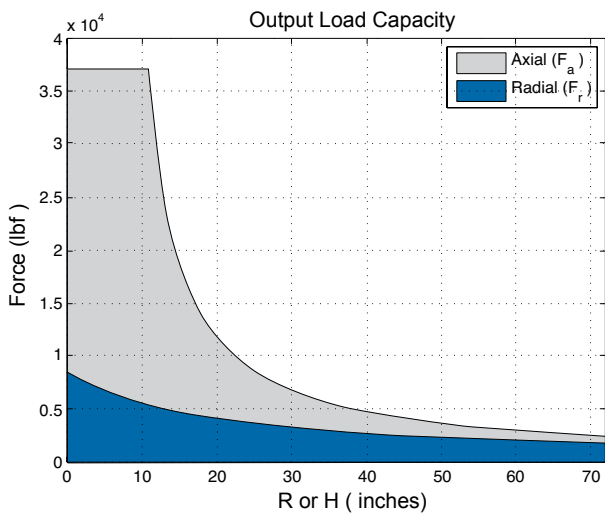

NOTE: Loads are for unidirectional loading only; for combined loading please contact Sankyo.

## 11kW Motor

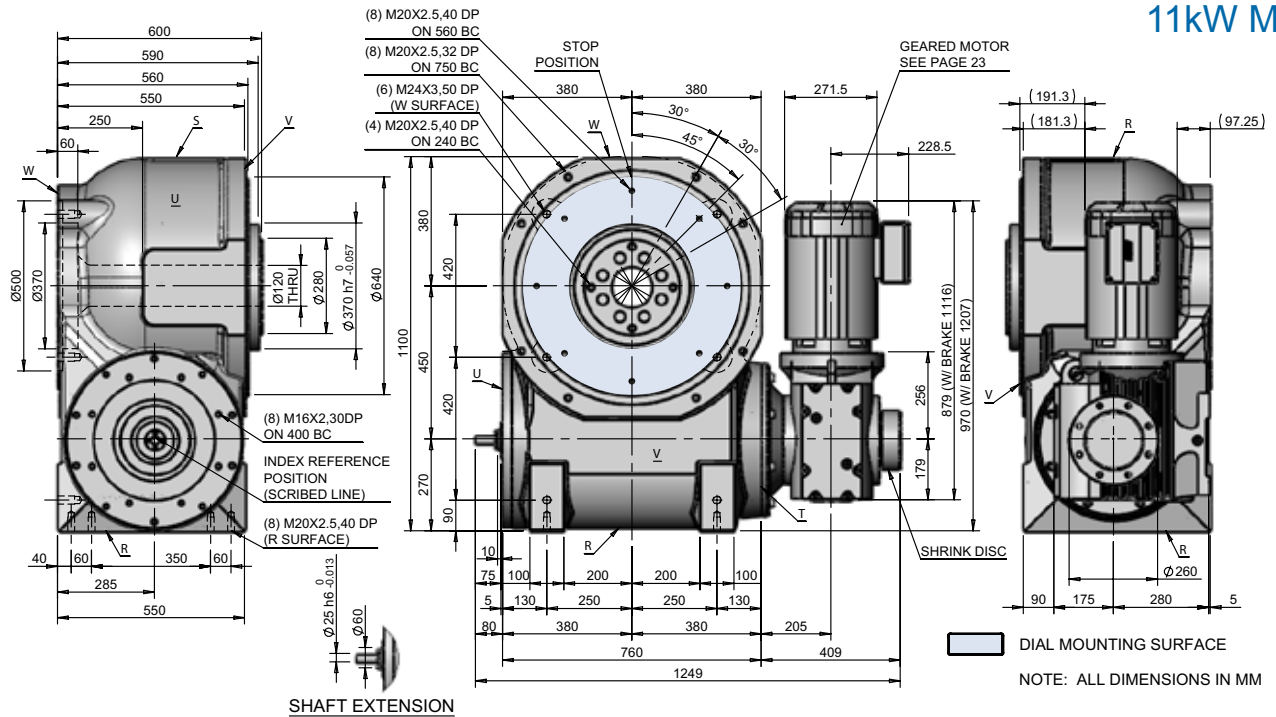

## 15kW Motor

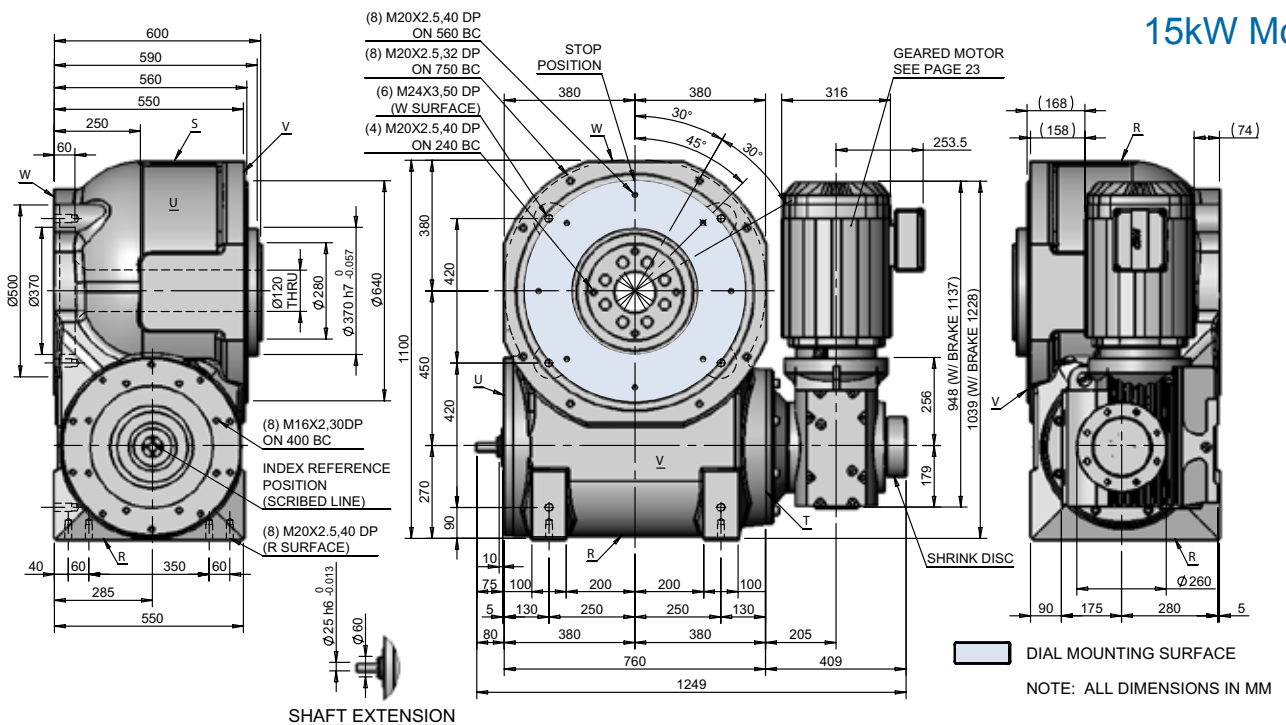

Standard Input Shaft (T surface side)

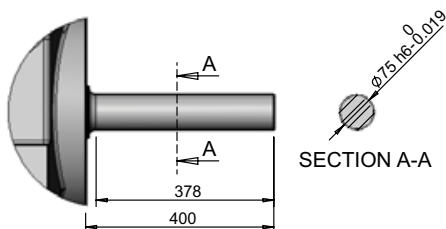

Output Fixed Flange Specifications

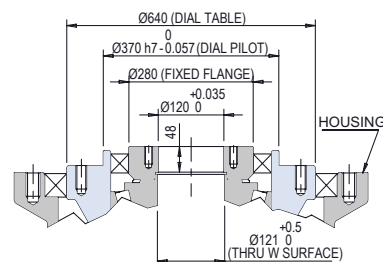

# Model Code

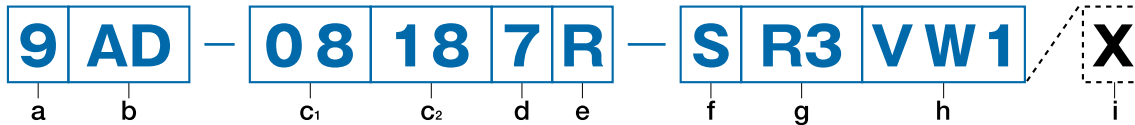

<b>a</b> Size	<b>9</b> 90mm	Shaft-to-shaft distance (These are available) <b>7, 9, 11, 15</b> <b>19, 23, 33, 45</b>	
<b>b</b> Model	<b>AD</b> Alpha Series	<b>AD</b> Alpha Series	
<b>c<sub>1</sub></b> Number of Stops (S)	<b>08</b> 8 Stop	Number of stops of the indexing drive.	
<b>c<sub>2</sub></b> Index Period (θ)	<b>18</b> 180°	Cam rotation period during which the output moves.	
<b>d</b> Motion Curve	<b>7</b> SMS-3 Curve	<b>7</b> SMS-3 Curve (Sankyo Modified Sine) <b>8</b> SMCV-3 Curve (Sankyo Modified Constant Velocity) <b>9</b> Custom-made Motion Curve (Special order)	
<b>e</b> Hand of Cam	<b>R</b> 1 Dwell Right Hand Cam	Indicates relationship between rotation direction of input and output shafts and indicates number of dwells. R is standard.  1 Dwell    2 Dwell Right Hand Cam <b>R</b> <b>R2</b> Note: 2 Dwell drives will index and dwell two times per one rotation of the camshaft. Left Hand Cam <b>L</b> <b>L2</b>	
<b>f</b> Output	<b>S</b> Standard	<b>S</b> Standard <b>L</b> Torque Limiter on output	
<b>g</b> Input Shaft Projection	<b>R3</b> Geared Motor on T Surface		
<b>h</b> Mounting	<b>VW1</b> Standard	Unit is completely filled with oil and can be mounted in any position.	
<b>i</b> Special Instruction	<b>X</b>	Include the symbol <b>X</b> in case of special orders <input type="checkbox"/> Standard (No Symbols) <input checked="" type="checkbox"/> Special Instructions Please contact Sankyo sales with any special instructions.	

## Model Selection Information

Sankyo model codes are specified by a combination of numbers and alphabetic characters. An erroneously specified product code will usually result in a product unusable in other applications. Use the same caution when specifying the product code for the geared motor and optional torque limiters. When specifying other requirements such as special gear ratios, motor voltages, copper plated terminal boxes, etc., include the symbol X at the end of the product code and attach a separate user requirements sheet. Queries concerning price, volume, and delivery should be directed to a Sankyo salesman or representative.

## Geared Motor

Model code example

**GM** **0.2** - **030** **D** **4** - **9AD** **1** -  

a            b            c            d            e            f            g

**OPTIONS**

Blank = N/A

**B** = Brake Motor

**W** = Washdown

a Model	b Motor Power	c Gear Ratio	d Motor Voltage	e Specification	f Model Size
<b>GM</b> Geared motor	Indicates the motor power <b>0.2</b> .....0.2kW <b>0.75</b> ...0.75kW	Indicates the gear ratio <b>10</b> .....10 <b>20.37</b> ..20.37	Indicates the motor voltage <b>D</b> 230/460V Other options available	Indicates the manufacturer of geared motor <b>4</b> Sankyo standard Other motors available	Indicates the size and model of indexer

**g**  
Mounting Positions

T-SURFACE

U-SURFACE

\* Other mounting positions available upon request

## Timing Cam & Sensor Model

Model code example

**TC** **D** **1** **U** - **9** **AD** - **PNP** - **NO** -  

a            b            c            d            e            f            g            h            i

a Model	b Sensor Type	c No. of Sets	d Std	e Model Size	f Model Type	g Polarity	h Control Logic	i No. of Dwells
<b>TL</b> Timing Cam & Sensor	<b>D</b> M12 Prox Switch with QD, 2M Cable, Bracket, Timing Cam, & Guard <b>E</b> Switch Mounting Bracket, Timing Cam, & Guard ONLY	<b>1</b> <b>2</b> <b>3</b> Special	<b>U</b> Std	<b>7</b> <b>9</b> <b>11</b> <b>15</b> <b>19</b> <b>23</b>	<b>AD</b> Std	<b>NPN</b> <b>PNP</b>	<b>NO</b> (Std) <b>NC</b> (Opt)	Blank=1 <b>2</b> <b>3</b>

# Timing Cam Prox Sensor

## Dimensions

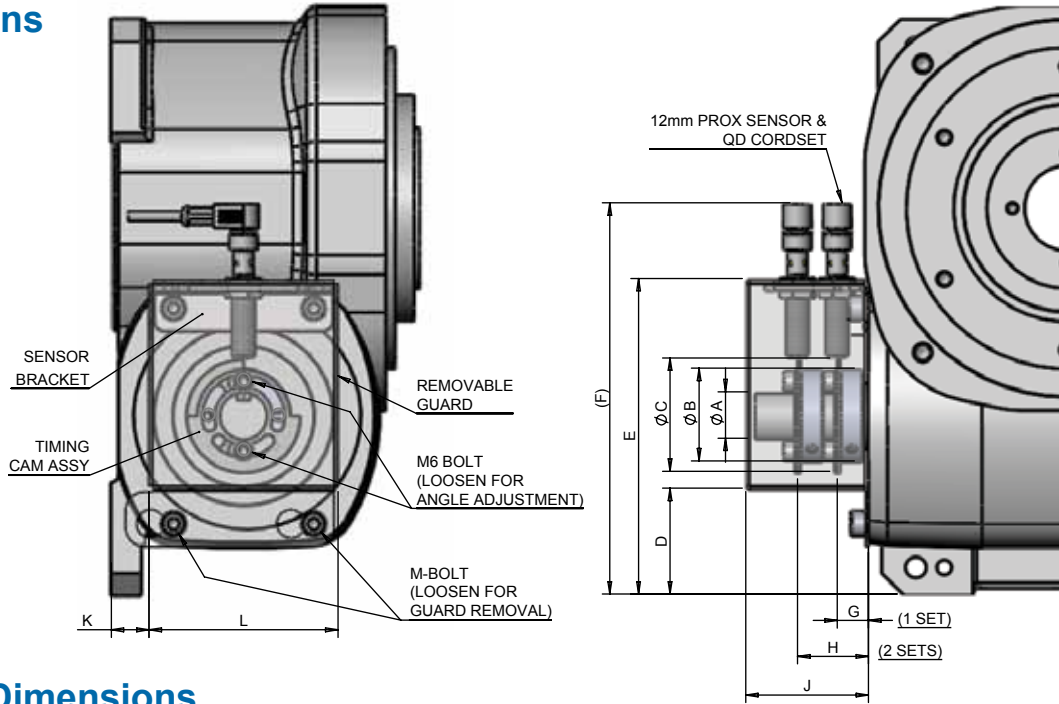

## Table of Dimensions

UNIT	A	B	C	D	E	(F)	G	H	J	K	L	M
7AD	17	40	50	41	127	183	15.5	36.5	58	10	80	M8
9AD	25	49	60	46	146	194	16.5	37.5	65	12	96	M8
11AD	25	49	60	56	167	206	16.5	37.5	65	20	100	M8
15AD	25	49	60	72	173	227	18.5	39.5	67	26	118	M10
19AD	25	49	60	82	209	279	18.5	39.5	67	42	146	M12
23AD	25	49	60	84	219	273	18.5	39.5	67	63	168	M12

## Control Block Diagram

The Alpha Series rotary indexing table is typically operated in a cycle-on-demand configuration. This means that for each machine cycle, a PLC commands the camshaft to rotate one revolution to advance the output table one position. The rotary table input shaft will then stay stationary in the dwell position until the PLC commands it to index again. A sensor package on the camshaft is used to indicate to the PLC when it has reached the dwell position. A variable frequency drive (VFD) is typically used to control the motor stops and starts and for speed control.

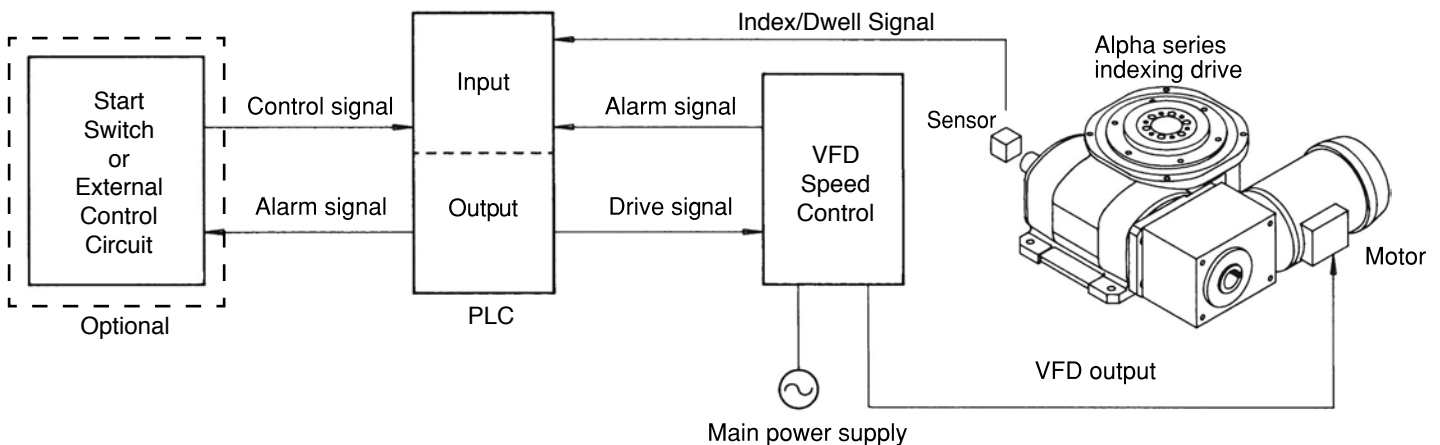



## TAD Series Flange to Flange Type, Hollow Center

### Description

Sankyo's TAD Series features a low profile, hollow center bore and a ground center pilot for flange mounted dial plates, gears, or sprockets. Sankyo's proprietary design uses a nine detent ball and pocket configuration to enhance lubrication while reducing the pocket vacuum, thus eliminating inconsistent overload conditions. Hardened metal components accommodate rotational shock loads during speed ramps to reduce pocket wear. Torque settings are easily adjusted by rotating the top plate. Multiple torque ranges are achieved by exchanging all or a partial group of die springs. Precision internal components produce low backlash, repetitive overload threshold in both directions while maintaining an overall high rigidity. Standard units are free spinning when the torque range is exceeded & automatically reset every 360° of rotation after the overload is removed. Optional overload monitoring sensor mounts in the hollow bore.



### Features

- Torque settings are adjustable by rotating the top plate; multiple torque ranges are achieved in less than 2 minutes by exchanging the springs.
- Compact design offers versatile mounting in any position & a standard option for our AD/Alpha index.
- Accurate resetting within ±30 arc seconds in either direction and large bending moment capacity.
- Unit is free-spinning during overload and automatically resets every 360° after cured overload condition.
- Optional proximity sensor detects when a torque limit setting has been exceeded or overloaded.

### Torque Limiter (option)

Model code example

<b>9</b>	<b>TAD</b>	<b>20</b>	<b>L</b>
a	b	c	d

a	b	c	d
Torque limiter size	Model	Maximum tripping torque(Tmax)	Type of spring
Indicates the size of the torque limiter <b>7</b> , <b>9</b> , <b>11</b> , <b>19</b> , <b>15</b> , <b>23</b> Choose same size as Alpha series	Indicates the type of torque limiter <b>TAD</b> Alpha-type	Indicates the maximum tripping torque <b>20</b> Tmax = 200N·m	Two types of springs are available: <b>L</b> , <b>H</b> <b>L</b> Light-duty coil springs <b>H</b> Heavy-duty coil springs

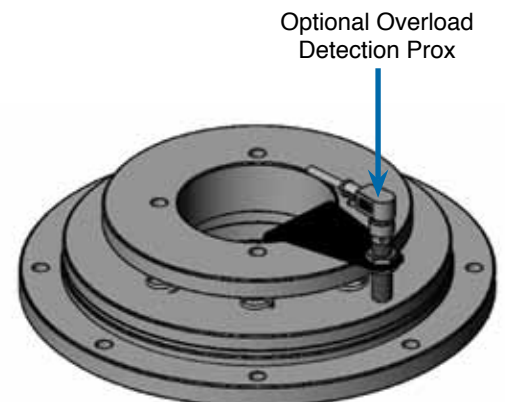

# TAD Series - Torque Limiting Clutch

## Dimensions

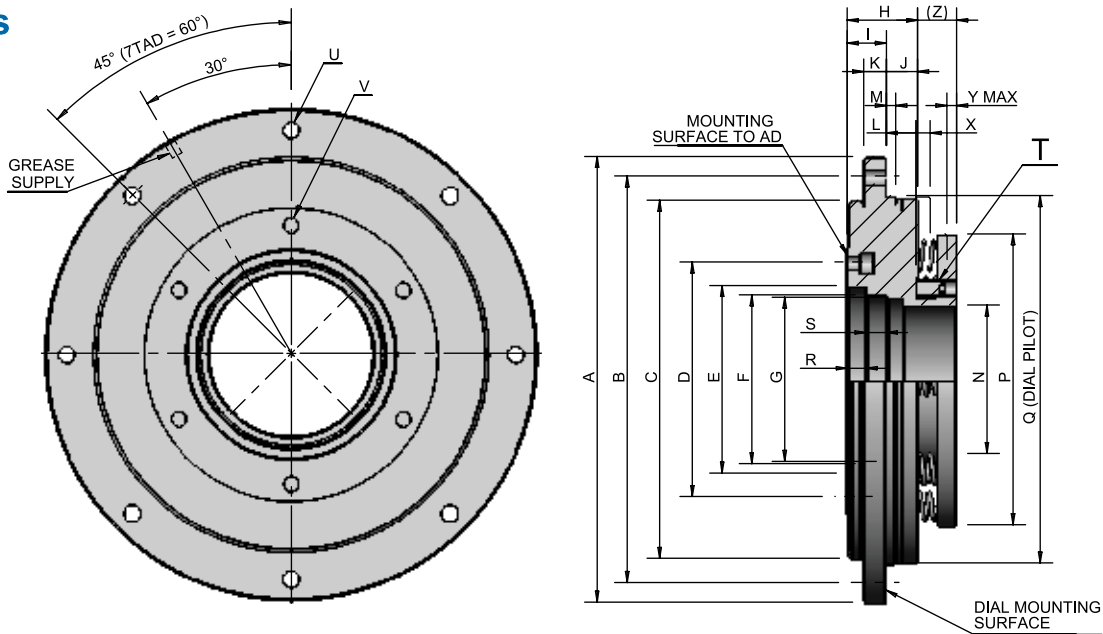

## Table of Dimensions

Table TAD-1

Model	A	B	C	D	E	F	G	H	I	J	K	L	M	N	P	Q	R	S	T	U	V	X	Y <sub>max</sub>	Z
7TAD	φ180	φ168	φ152	φ85	φ70 H7	φ60	M55 ×2	33	19	14	10.5	14	5	φ47	φ107	φ155 h7	7	10	(4) M5	(6)M5 ×0.8	(6) 6.6DR.	3	5	16.5
9TAD	φ240	φ220	φ198	φ120	φ100 H7	φ85	M80 ×2	39	22.5	16.5	12.5	17.5	5	φ70	φ158	φ200 h7	7	16	(4) M10	(8)M8 ×1.25	(6) 6.6DR.	3.5	7	23
11TAD	φ285	φ260	φ229	φ150	φ120 H7	φ108	M105 ×2	44	25	19	14.5	20	6	φ95	φ186	φ235 h7	12	13	(4) M10	(8)M10 ×1.5	(6) 9DR.	3.7	7.5	26
15TAD	φ395	φ365	φ328	φ210	φ172 H7	φ155	M145 ×2	64	37	27	20	27	6	φ130	φ256	φ335 h7	12	33	(4) M10	(8)M12 ×1.75	(6) 11DR.	5.5	7	26
19TAD	φ480	φ450	φ419	φ260	φ230 H7	φ186	M180 ×2	77	42	35	21	33	8	φ166	φ326	φ420 h7	16	43	(4) M10	(8)M12 ×1.75	(8) 14DR.	5.6	7	34
23TAD	φ555	φ525	φ494	φ336	φ275 H7	φ262	M260 ×2	82	47	35	25	35	9	φ246	φ402	φ495 h7	17	44	(4) M10	(8)M14 ×2	(8) 14DR.	6.5	8	36

[Unit : mm]

## Specifications

Table TAD-2

Model	Code	Range of Tripping Torque (N·m)	Thread Pitch On Torque Adjusting Nut (mm)	Max. Allowable Radial Load (N)	Max. Allowable Thrust Load (N)	Max. Allowable Bending Moment (N·m)	Max. Revolution Per Minute (r.p.m.)	Moment of Inertia (kg·m <sup>2</sup> )	Mass (kg)
7TAD	7TAD-15L	40 ~ 150	2	2450	2950	45	200	0.02	4.5
	7TAD-25H	100 ~ 250							
9TAD	9TAD-20L	60 ~ 200	2	5200	5000	100	200	0.07	9.6
	9TAD-45H	140 ~ 450							
11TAD	11TAD-23L	90 ~ 230	2	7300	7000	180	200	0.15	15
	11TAD-60H	150 ~ 600							
15TAD	15TAD-100L	300 ~ 1000	2	11800	12000	430	140	0.8	43
	15TAD-220H	650 ~ 2200							
19TAD	19TAD-200L	600 ~ 2000	2	16800	17000	750	120	2.1	74
	19TAD-450H	1500 ~ 4500							
23TAD	23TAD-350L	1200 ~ 3500	2	24800	35000	1950	100	4.5	110
	23TAD-550H	2000 ~ 5500							

X: When an overload occurs, the overload detection panel moves X mm. This movement is used to activate a sensing device and thereby allows the user to take appropriate measures in the control logic.

Z: This dimension indicates the height when the spring is free and should be referred to when calculating tripping torque.

Y<sub>max</sub>: This dimension indicates tightening length when tripping torque is maximum. If tightening more than this figure, the torque limiter does not operate.

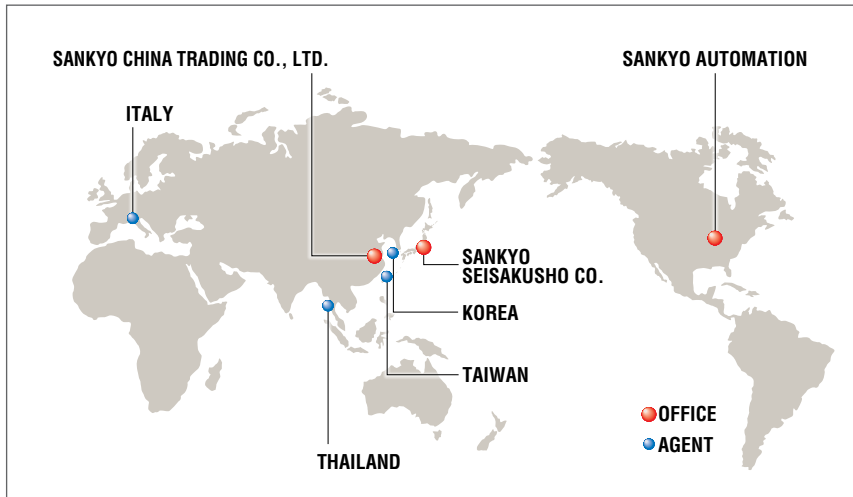

■ 10655 State Route 47  
 Sidney, Ohio 45365 U.S.A.  
 PHONE: (937) 498-4901 • FAX: (937) 498-9403  
 E-mail: [sales@sankyoautomation.com](mailto:sales@sankyoautomation.com)  
 URL: <http://www.sankyoautomation.com>

## Locations

### SANKYO SEISAKUSHO CO.

3-37-3 Tabatashinmachi, Kita-ku,  
 Tokyo, Japan 114-8538  
 Phone: +81-3-3800-3330 • Fax: +81-3-3800-3380  
 E-mail: [overseas@sankyo-seisakusho.co.jp](mailto:overseas@sankyo-seisakusho.co.jp)  
 URL: <http://www.sankyo-seisokusho.co.jp>

### SANKYO CHINA TRADING CO., LTD.

Room 1103, Block B, No.391 Guiping Road,  
 Shanghai 200233 China  
 Phone: +86-21-5445-2813 • Fax : +86-21-5445-2340  
 E-mail: [sales@sankyochina-trading.com](mailto:sales@sankyochina-trading.com)  
 URL: <http://www.sankyochina-trading.com/>

### SANKYO SEISAKUSHO CO. KOREA

443-734  
 103-1105, Digital Empire 2, 486 Shin-dong, Youngtong-gu, Suwon-si, Kyeonggi-do, South Korea  
 Phone: +82 31 (695) 5801 • Fax : +82 31 (695) 5803

### SANKYO SEISAKUSHO CO. TAIWAN

20F-3, No.6, Ln. 256, Sec. 2, Xitun Rd., Xitun Dist., Taichung City 40749, Taiwan (R.O.C.)  
 Phone: +886-4-2451-6648 • Fax : +886-4-2451-6848

Represented by:



10655 State Route 47  
Sidney, Ohio 45365  
Phone: (937) 498-4901  
[www.sankyoautomation.com](http://www.sankyoautomation.com)

Sankyo America Inc. D.B.A. Sankyo Automation.

Specifications and dimensions are subject to change without notice. Consult Sankyo sales before ordering.

Patent rights and copyrights for some mechanisms, trademarks, images, drawings and other material in this catalog all belong to Sankyo Seisakusho Co.