

# TWIN OPEN SERIES

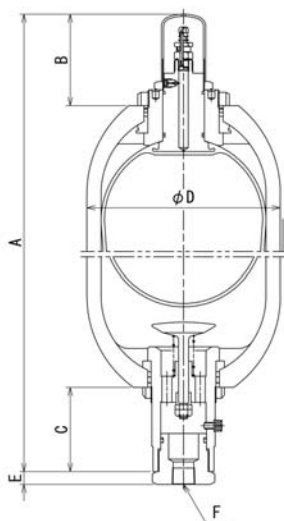

### Features :

- A large opening is provided on the top for ease of maintenance.
- Because the bladder is pear-shaped to expand and contract easily, the excessive deformation tends not to occur and the life span is long.
- The bladder body doesn't have a seal structure, so special skill for maintenance is not required.
- In the way of customer's convenience the bladder can be replaced from both ports in top and bottom.
- The shell body has assembly structure without screw clamps, so customer is free from stripped screws trouble in disassembly.

### Model symbols :

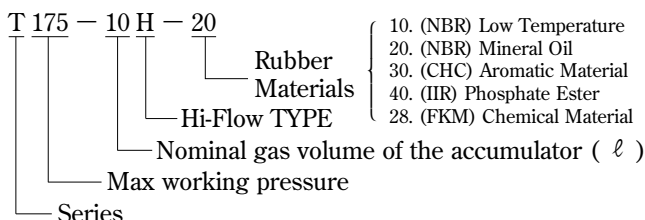

Model	Dimensions	Max W.P. (MPa)	Gas volume (ℓ)	Mass (kg)	A (mm)	B (mm)	C (mm)	D (mm)	E (mm)	F	Max allowable discharge flow (ℓ/min)
T175-10	-20	17.2	11.6	45	673	110	106	232	15	Standard unit comes with a bushing Rc3/4 connection. As to a flange connection, refer to page 16.	1400
	-30		20.4	62	946						
	-50		36.8	97	1457						
	-60		52.7	129	1965						
	-10H		64.3	153	2331						
	-20H		10.9	60	662						
T230-10	-20	22.6	10.3	56	673	107	101	241.8	15	Standard unit comes with a bushing Rc3/4 connection. As to a flange connection, refer to page 16.	1400
	-30		18.8	80	946						
	-50		33.8	128	1457						
	-60		48.3	173	1965						
	-10H		59.0	207	2331						
	-20H		9.6	71	664						
T350-10	-20	34.4	18.2	95	937	103	103	241.8	15	Standard unit comes with a bushing Rc3/4 connection. As to a flange connection, refer to page 16.	1400
	-30		33.2	143	1448						
	-50		47.7	188	1956						
	-60		58.3	222	2322						
	-10H		9.6	84	663						
	-20H		17.9	119	941						
T120-40	-40	11.8	43.0	110	918	110	108	355.6	15	Standard unit comes with a bushing Rc3/4 connection. As to a flange connection, refer to page 16.	3600
	-58		61.0	136	1144						
	-80		79.0	162	1364						
	-120		127.0	234	1968						
	-180		183.0	316	2666						
	-40		41.0	155	918						
T175-40	-58	17.2	58.0	192	1144	105	103	355.6	15	Standard unit comes with a bushing Rc3/4 connection. As to a flange connection, refer to page 16.	3600
	-80		75.0	227	1364						
	-120		120.0	323	1956						
	-170		170.0	439	2670						
	-40		167.0	423	2046						
	-230		222.0	549	2652						
TL175-170	-170	22.6	167.0	423	2046	102	100	406.4	15	Standard unit comes with a bushing Rc3/4 connection. As to a flange connection, refer to page 16.	3600
	-230		222.0	549	2652						
	-40		37.0	177	918						
	-58		54.0	222	1144						
	-75		70.0	270	1364						
	-120		112.0	391	1956						
T230-40	-170	22.6	164.0	535	2670	105	103	355.6	15	Standard unit comes with a bushing Rc3/4 connection. As to a flange connection, refer to page 16.	3600
	-40		37.0	177	918						
	-58		54.0	222	1144						
	-75		70.0	270	1364						
	-120		112.0	391	1956						
	-170		164.0	535	2670						
TL230-160	-160	34.4	157.0	531	2056	102	100	406.4	15	Standard unit comes with a bushing Rc3/4 connection. As to a flange connection, refer to page 16.	3600
	-220		213.0	689	2662						
	-40		35.0	214	918						
	-58		51.0	267	1144						
	-70		66.0	321	1364						
	-100		103.0	459	1950						
TL350-160	-160	34.4	155.0	636	2700	105	103	355.6	15	Standard unit comes with a bushing Rc3/4 connection. As to a flange connection, refer to page 16.	3600
	-160		155.0	636	2700						
	-160		152.0	609	2056						
	-220		205.0	792	2662						
	-160		152.0	609	2056						
	-220		205.0	792	2662						

© Refer to page 16 for flange connection.

© Maximum allowable discharge flow is designed in the case where the fluid material is mineral oil VG46.