

XRS-160

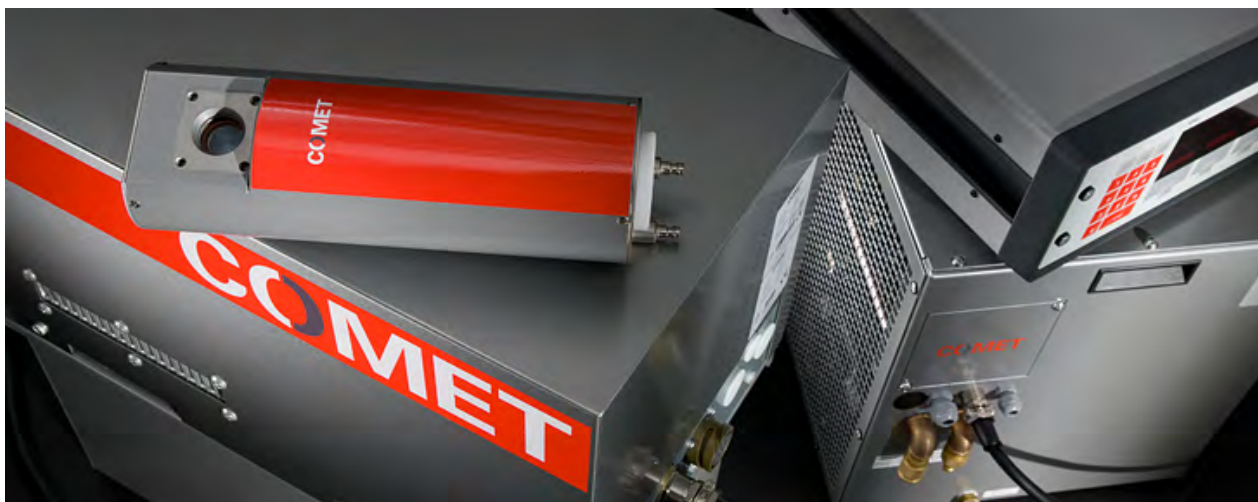

Customer Benefits

- Stepless control of kV and mA
- Easy to install, operate and integrate
- Suitable for factory floor application
- Higher penetration, shorter exposure times
- Best-in-class performance and reliability
- Arc resistant design increases efficiency
- In-house test of complete module

Tube, Cable, Cooler

TUBE	Ordering No.
MXR-160/21	915302.51
MXR-160/22	915301.51
MXR-160HP/20	915357.51
MXR-160HP/FB	915359.51
MXR-160HP/11	915370.51
MXRP-160C	915311.51
MXR-165	915356.51
HIGH VOLTAGE CABLE	
	Ordering No.
N3/160-R24SL-R24SL-5m	20031101
N3/160-R24SL-R24SL-10m	20031103
N3/160-R24SL-R24SL-15m	20031104
COOLER/CHILLER	
	Ordering No.
XRC-3001-WA (Cooler water/air)	10008640
XRC-3001-WW (Cooler water/water)	10008641
XRCA-3001-WA (Chiller water/air)	20033337

Technical Specs XRP-160

GENERATOR XRP-160/2250/2

Voltage range	7.5– 160 kV
Adjustment increments (minimum step)	0.1 kV / step
Accuracy	+/-1 %
Reproducibility (at constant temperature)	+/-0.01 %
High voltage ripple (with 10m high voltage cable)	5 V/mA, min. 20V
Temperature induced drift	80 ppm/°C
Current range	0–22.5 mA (*0-45mA)
Adjustment standard range	0.05mA increments
High resolution range (recommended)	0.01 mA steps
Accuracy (at constant temperature)	+/-0.2% of output value +/-0.01%mA
Reproducibility (at constant temperature)	+/-2 µA
Temperature induced drift	50 ppm/°C
Maximum power	2250W (*4500W)
High voltage connector type	R24
Control Unit	
XRG	
Dimensions (WxHxD) mm	483 mm x 133 mm x 300 mm
Weight	12.5 kg
Power Supply	
XRP-Power	
Dimensions (WxHxD) mm	340 mm x 200 mm (*350 mm) x 628 mm
Weight	26 kg (*45 kg)
High Voltage Tank (Oil Insulated)	
XRP-T160K	
Dimensions (WxHxD) mm	375 mm x 335 mm x 625 mm
Weight	80 kg

*for XRP-160/4500/2

COMET

Technology with Passion

COMET AG, Herrngasse 10, CH-3175 Flamatt
 T +41 31 744 90 00, F +41 31 744 90 90
 info@comet-xray.com, www.comet-xray.com

Unipolar X-Ray Source

Diagram of a Unipolar X-Ray Source XRS and its environment.

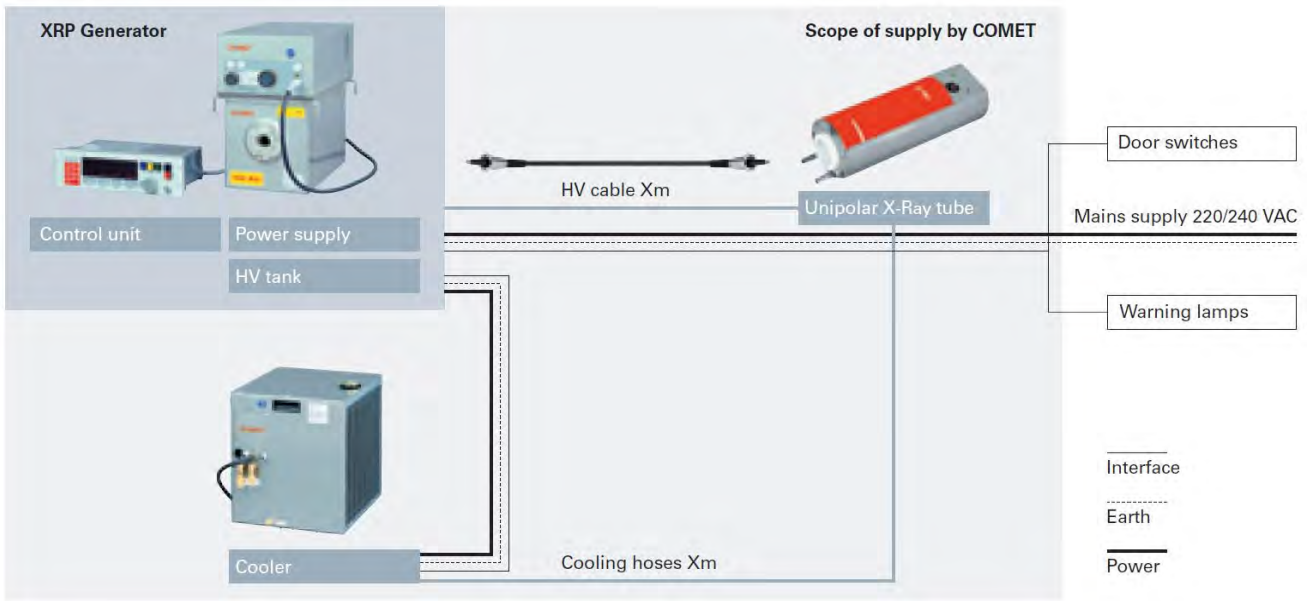

XRS-160 configurations

Examples of XRS-160 configurations

TUBE				CABLE	GENERATOR	COOLER
Type	Continuous rating	Focal spot acc. EN 12543	Radiation coverage	Type	Type	Type
MXR-160/21	640W/1600W	d=1.0/3.0mm	40°	N3/160-R24SL-R24SL-Xm	XRP-160/2250/2	XRC-3001-WA
MXR-160/22	640W/3000W	d=1.0/5.5mm	40°	N3/160-R24SL-R24SL-Xm	XRP-160/4500/2	XRC-3001-WA
MXR-160HP/20	1000W/1000W	d=1.0/1.0mm	40°	N3/160-R24SL-R24SL-Xm	XRP-160/2250/2	XRC-3001-WA
MXR-160HP/FB	1000W	d=1.0mm	60°x25°	N3/160-R24SL-R24SL-Xm	XRP-160/2250/2	XRC-3001-WA
MXR-160HP/11	800W/1800W	d=0.4*/1.0mm	40°x30°	N3/160-R24SL-R24SL-Xm	XRP-160/2250/2	XRC-3001-WA
MXRP-160C	1000W	d=0.4/4.0mm	360°x40°	N3/160-R24SL-R24SL-Xm	XRP-160/2250/2	XRC-3001-WA
MXR-165	6000W	d=5.5mm	45°	N3/160-R24SL-R24SL-Xm	XRP-160/4500/2	XRC-3001-WA

*Threshold: 30 %

Outline drawings

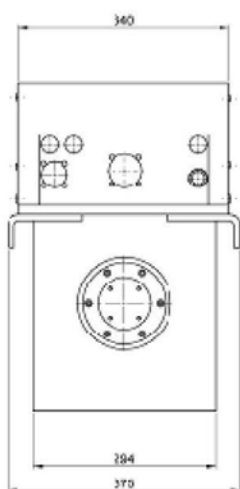

Generator XRP-160/2250/2

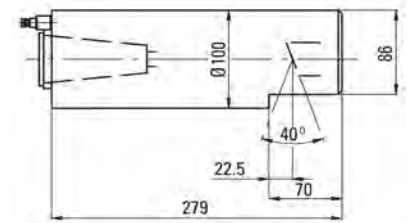
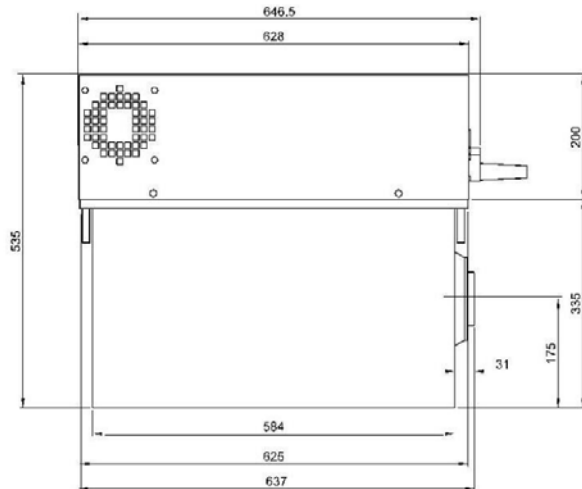

Standard tube version

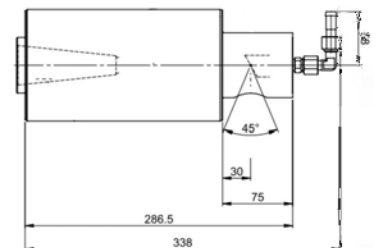

MXR-165 tube version