

MICROWAVE FLOW MONITOR

Relative Monitoring Type Powder Flow Sensor

***Monitors relative flow rate inside
a multi-branched piping system***

Monitoring and controlling the balance of flow rates inside powder transporting pipes that branch from the main line are an important issue in plant operations. Conventionally, however, online monitoring of the flow rate has been extremely difficult and expensive. When mounted on each branch pipe with the same settings applied to all units, the Microwave Flow Monitor can inexpensively monitor the flow rate of all the branch pipes.



Features

- With use of multiple units, flow rate monitoring is possible for individual pipes.
- Since individual flows are monitored, it is possible to monitor the rate even with dozens of branch pipes.
- The use of microwave technology enables no projections inside the pipes.
- High accuracy assured as the density level and flow rates are detected by microwave.
- Applicable for pipe diameters up to 200 mm.
- Easily mounted with a one-inch screw, even on existing pipes.



Specifications

Model	MWFM-AN-01	Allowable temperature	-20°C~+80°C(measuring objects)
Power supply	80 VAC to 240 VAC at 50/60Hz	Ambient temperature	-10°C to 55°C
Detection Method	Outputs powder flow rate detected by using microwaves based on the Doppler effect.	Allowable pressure	Max. 0.5Mpa
Frequency	24GHz	Mounting	G1 screw
Oscillation power	Approx. 6.6 mW or less	Protection	IP65
Relative rate accuracy (Repeatability)	±5%(with stable powder property)	Coating color	Munsell 7.5GY6/10
Output	Current output 4mA to 20mADC (optional setting possible) Max. load resistance 600 Ω At fault, Analog output drops to 0mA	Mass	Approx. 1.8kg

Dimensions (in mm) and Terminal Connections

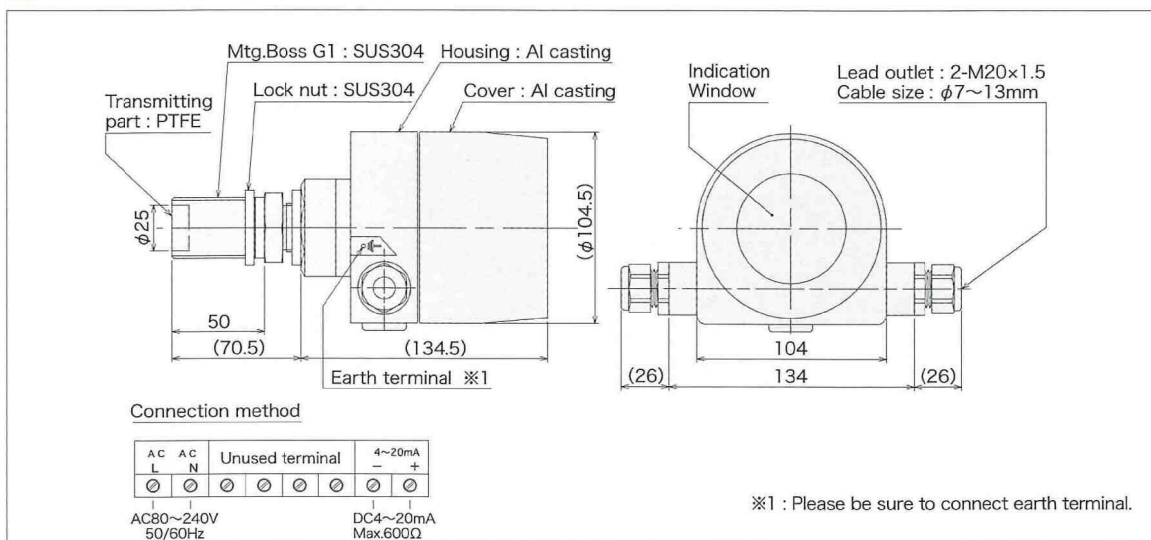

Application

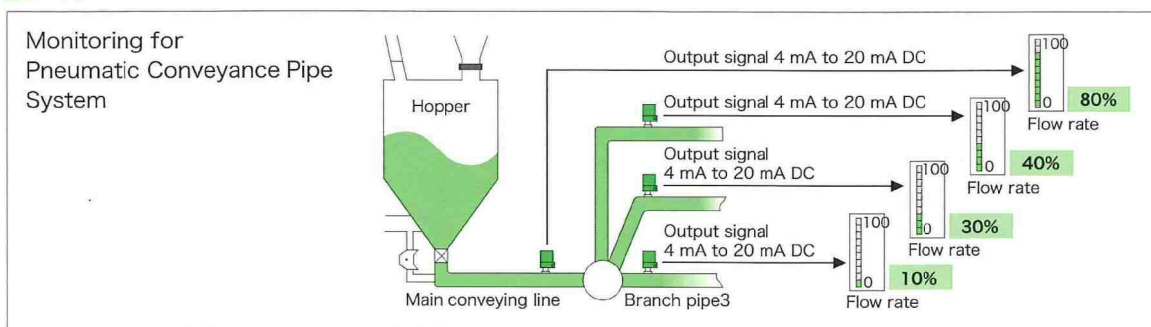

All Rights Reserved Copyright©2011, Matsushima Machinery Laboratory Co., Ltd.

Distributor



Matsushima Measure Tech Co., Ltd.

HEAD OFFICE
1-8-18, NORIMATSU-HIGASHI, YAHATANISHI-KU, KITAKYUSHU, 807-0837 JAPAN
Tel: +81-93-691-3731 FAX: +81-93-691-3735

Pohang Representative Office
Odyssey Bldg. 1F, 41, Jukdo-ro 28beon-gil, Buk-gu, Pohang-si, Gyeongsangbuk-do, 791-841, Korea
Tel: +82-(0)54-274-3731 FAX: +82-(0)54-274-3731

Chicago Representative Office
1600 GOLF ROAD, SUITE 1200, ROLLING MEADOWS, IL 60008, USA
Tel: +1-847-981-4742 FAX: +1-847-890-6688

Affiliated company
Shanghai Dahong Matsushima Machinery Co., Ltd.
70 Hengchang Road, Dahong, Malu, Jiading, Shanghai 201818, China
Tel: +86-(0)21-5951-4138 FAX: +86-(0)21-5951-4139
<http://www.matsushima-m-tech.com> E-mail: info@matsushima-m-tech.com